

HOTCYCLE™



No. 96110

Maximum Weight: 70 lbs. (31.8kg).
Poids maximal: 31,8 kg (70 lb).
Peso Máximo: 70 lbs. (31.8 kg).

16" RIDE-ON CYCLE INSTRUCTIONS

WARNING:
CHOKING HAZARD-Small Parts
PUNCTURE HAZARD-Sharp Points
Keep screws away from small children.
Adult Assembly Required.

MISE EN GARDE:
DANGER DE SUFFOCATION-Petites pièces
DANGER DE CREVAISON-Pièces pointues
Tenir les vis hors de portée des jeunes enfants.
Assemblage par un adulte recommandé.

ADVERTENCIA:
PELIGRO DE ATRAGANTAMIENTO-Piezas Pequeñas
PELIGRO DE PONCHADURA-Puntas Puntiguadas
Mantenga los tornillos fuera del alcance de niños pequeños.
Debe Ser Ensamblado Por un Adulto.

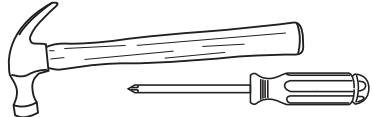

Hammer and Phillips head screwdriver required for assembly.

Marteau et tournevis à pointe étoilée requis pour l'assemblage.

Martillo y Destornillador Phillips requeridos para la armadura.

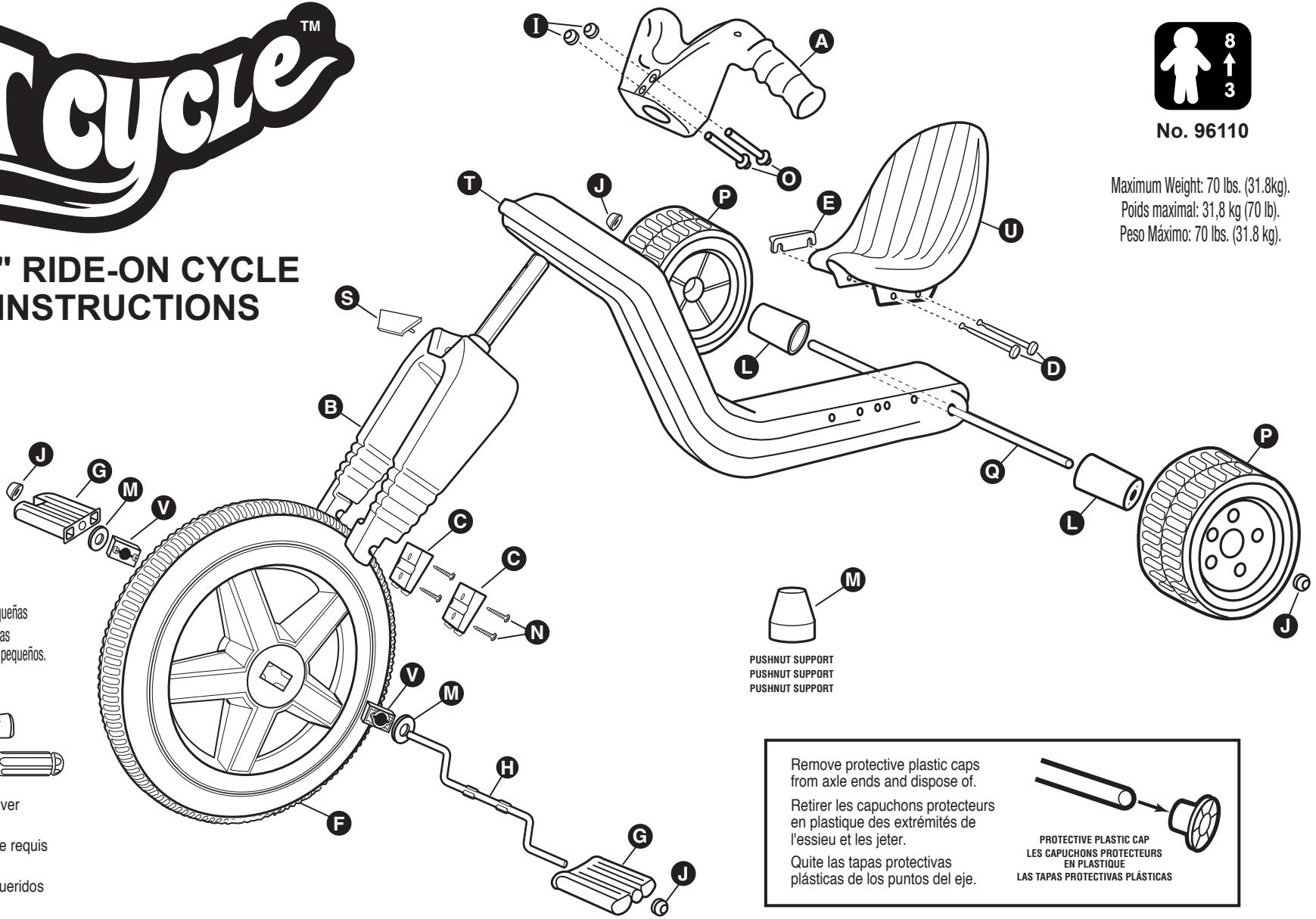

PUSHNUT SUPPORT
PUSHNUT SUPPORT
PUSHNUT SUPPORT

Remove protective plastic caps from axle ends and dispose of.

Retirer les capuchons protecteurs en plastique des extrémités de l'essieu et les jeter.

Quite las tapas protectoras plásticas de los puntos del eje.



PROTECTIVE PLASTIC CAP
LES CAPUCHONS PROTECTEURS EN PLASTIQUE
LAS TAPAS PROTECTIVAS PLÁSTICAS

WARNING: TO AVOID SERIOUS INJURY:
Continuous adult supervision required; never use near steps, sloped driveways, hills, roadways, alleys nor near motor vehicles; swimming pool areas; always wear shoes, and never allow more than one rider. Please inspect the rider for loose or damaged parts, monthly.

MISE EN GARDE: POUR PRÉVENIR LES BLESSURES GRAVES:
La supervision continue d'un adulte est requise; ne jamais utiliser le jouet à proximité d'escaliers, d'entrées de garage inclinées, de chaussées en pente, de rues passantes, de véhicules à moteur ou de piscines; toujours porter des chaussures et ne pas laisser plus d'un enfant à la fois s'asseoir sur le tricycle. Inspecter le tricycle une fois par mois pour repérer les pièces desserrées ou endommagées.

ADVERTENCIA: PARA EVITAR LESIÓN SERIA:
Se requiere supervisión adulta continua; no usar cerca de escalones, entradas a garajes con declive, lomas, caminos, callejones, ni cerca de vehículos automotores o albercas; use siempre zapatos, y nunca permita más de un pasajero. Por favor inspeccione el carrito una vez al mes para piezas sueltas o dañadas.

TRIKE PARTS LIST					
#	DESCRIPTION	QTY	#	DESCRIPTION	QTY
A	HANDLEBAR	1	L	SUPPORT CUP	2
B	FORK	1	M	3/8" WASHER	2
C	FORK CAP	2	N	3/4" SCREWS	4
D	SEAT PINS	2	O	3 3/4" CAPPED AXLES	2
E	SEAT CLIP	1	P	REAR WHEELS	2
F	FRONT WHEEL	1	Q	REAR AXLE	1
G	PEDALS	2	R	LABEL SHEET	1
H	FRONT DRIVE AXLE	1	S	FORK PLATE	1
I	1/4" PUSHNUT	2	T	BODY	1
J	3/8" PUSHNUT	4	U	SEAT	1
K	PUSHNUT SUPPORT	1	V	DRIVE INSERT	2

LISTE DES PIÈCES DU TRICYCLE					
#	DESCRIPTION	QTE	#	DESCRIPTION	QTE
A	GUIDON	1	L	?	2
B	FOURCHE	1	M	?	2
C	?	2	N	VIS 3/4"	4
D	?	2	O	?	2
E	?	1	P	ROUES ARRIÈRE	2
F	ROUE AVANT	1	Q	ESSIEU ARRIÈRE	1
G	PÉDALES	2	R	FEUILLE D'ÉTIQUETTES	1
H	ESSIEU AVANT	1	S	PLAQUETTE DE FOURCHE	1
I	?	2	T	CHÂSSIS	1
J	?	4	U	SIÈGE	1
K	?	1	V	?	2

LISTA DE PIEZAS DE TRICICLO					
#	DESCRIPCIÓN	CAN	#	DESCRIPCIÓN	CAN
A	MANILLARES	1	L	?	2
B	HORQUILLA	1	M	?	2
C	?	2	N	3/4" TORNILLOS	4
D	?	2	O	?	2
E	?	1	P	RUEDAS TRASERAS	2
F	RUEDA DELANTERA	1	Q	EJE TRASERO	1
G	PEDALES	2	R	HOJA DE ETIQUETA	1
H	EJE DELANTERO	1	S	PLACA DE HORQUILLA	1
I	?	2	T	CUERPO	1
J	?	4	U	ASIENTO	1
K	?	1	V	?	2

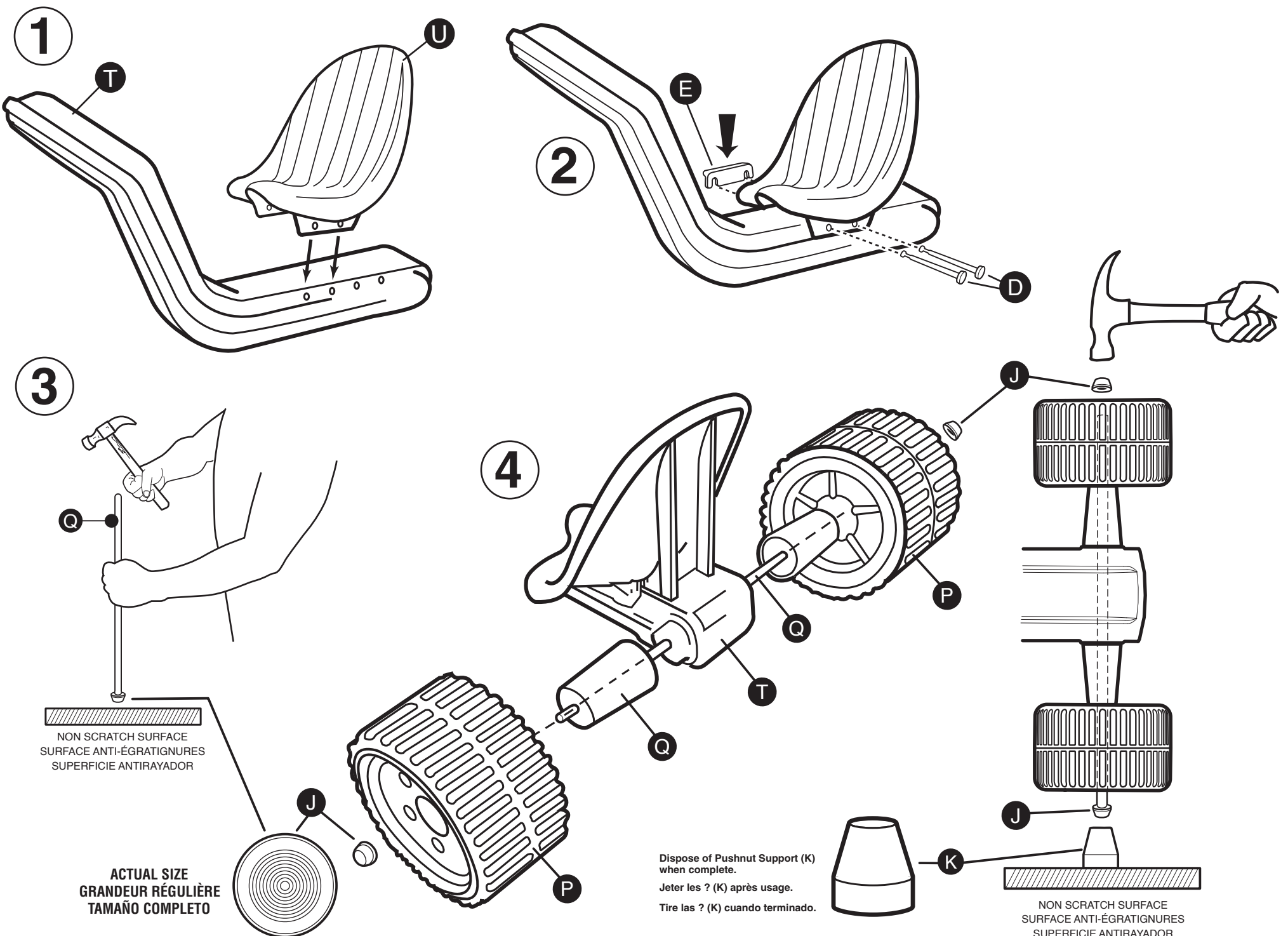

NON SCRATCH SURFACE
SURFACE ANTI-ÉGRATIGNURES
SUPERFICIE ANTIRAYADOR

ACTUAL SIZE
GRANDEUR RÉGULIÈRE
TAMAÑO COMPLETO

Dispose of Pushnut Support (K) when complete.
Jeter les ? (K) après usage.
Tire las ? (K) cuando terminado.

NON SCRATCH SURFACE
SURFACE ANTI-ÉGRATIGNURES
SUPERFICIE ANTIRAYADOR

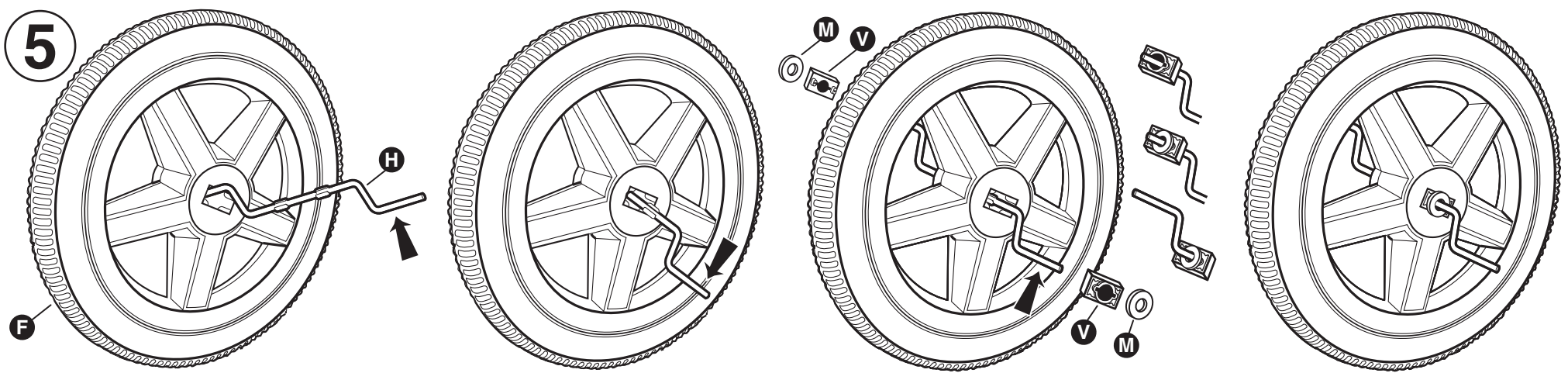

CAUTION: DO NOT INSTALL BOTH PEDALS (G) TO THE FRONT DRIVE AXLE (H) UNTIL AXLE IS PUSHED THROUGH WHEEL!

ATTENTION: INSÉRER L'ESSIEU AVANT (H) À TRAVERS LA ROUE AVANT D'INSTALLER LES PÉDALES (G) SUR L'ESSIEU!

CUIDADO: NO INSTALE AMBOS PEDALES (G) CONDUCE EJE DELANTERO (H) HASTA QUE EJE SEA HECHO ACEPTADO A LA RUEDA!

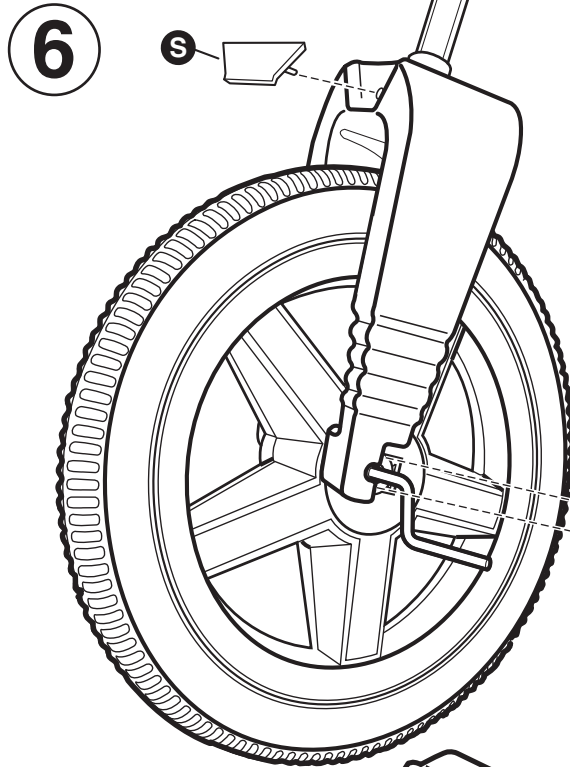

NOTE: Turn screws until tight. DO NOT OVERSCREW.

À NOTER: Bien serrer les vis. NE PAS TROP SERRER.

NOTA: Atornille los tornillos hasta se apretan. NO SE APRETE DEMASIADO.

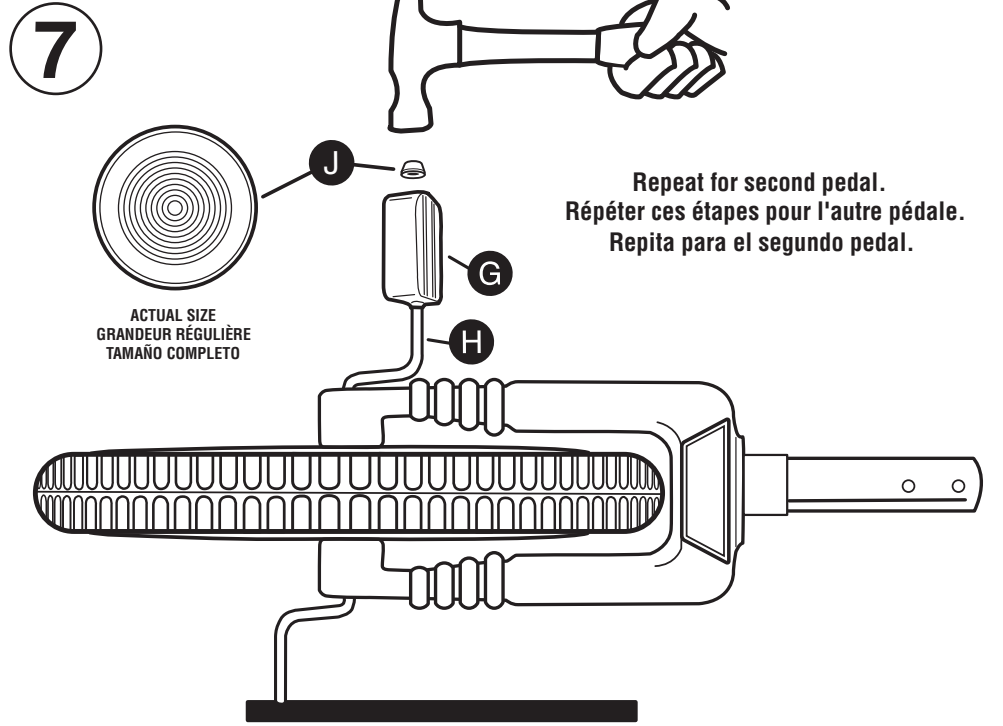
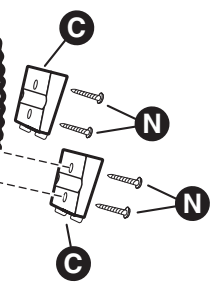

Repeat for second pedal. Répéter ces étapes pour l'autre pédale. Repita para el segundo pedal.

NON SCRATCH SURFACE SURFACE ANTI-ÉGRATIGNURES SUPERFICIE ANTIRAYADOR

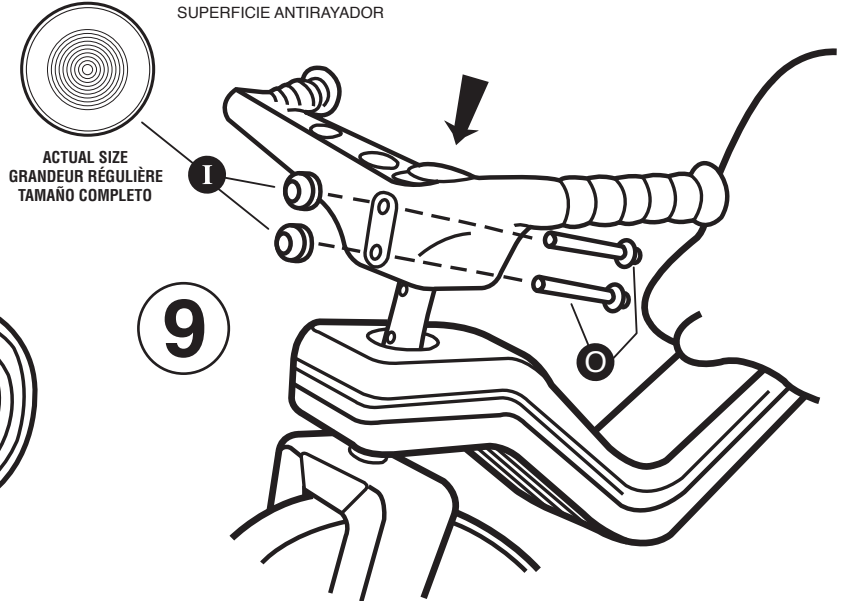
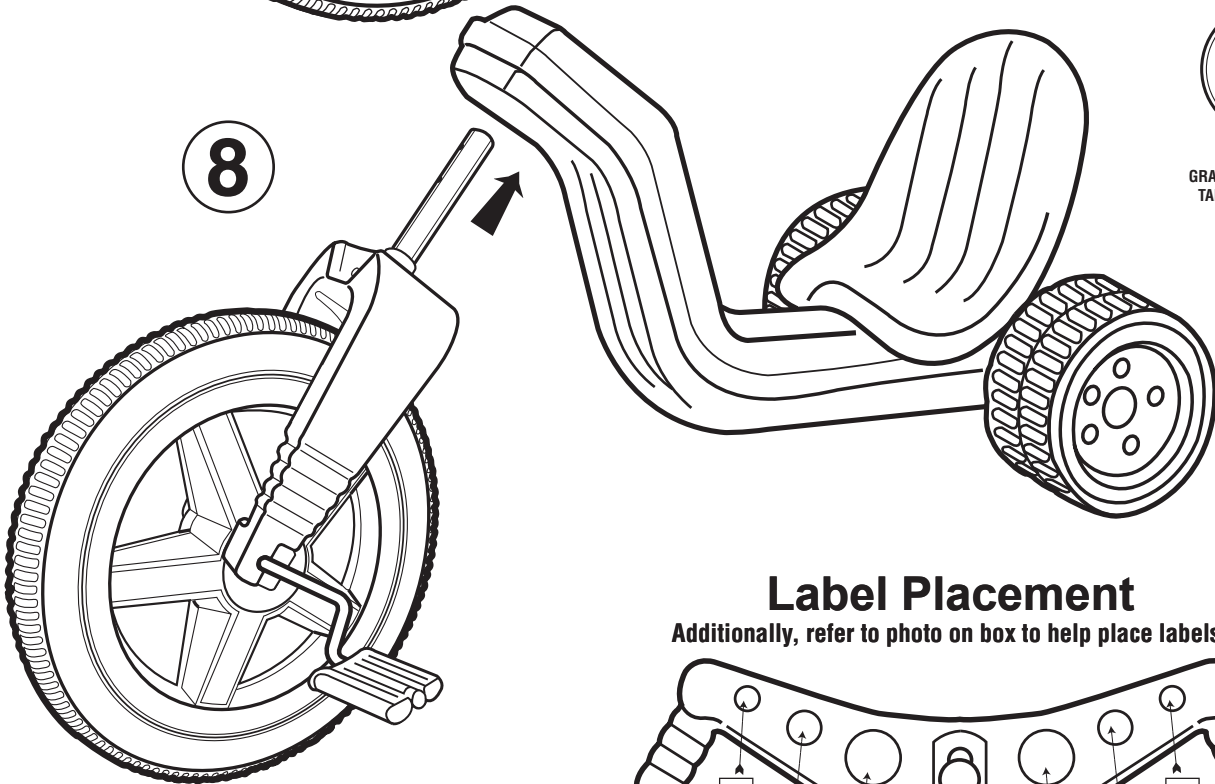

Label Placement

Additionally, refer to photo on box to help place labels.

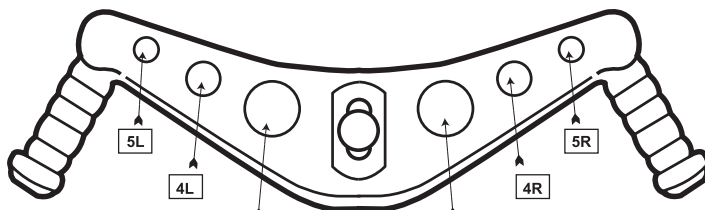

**Handlebar Labels
Calcomanías del manubrio
Autocollants du guidon**

Vue des autocollants

Additionally, refer to photo on box to help place labels.

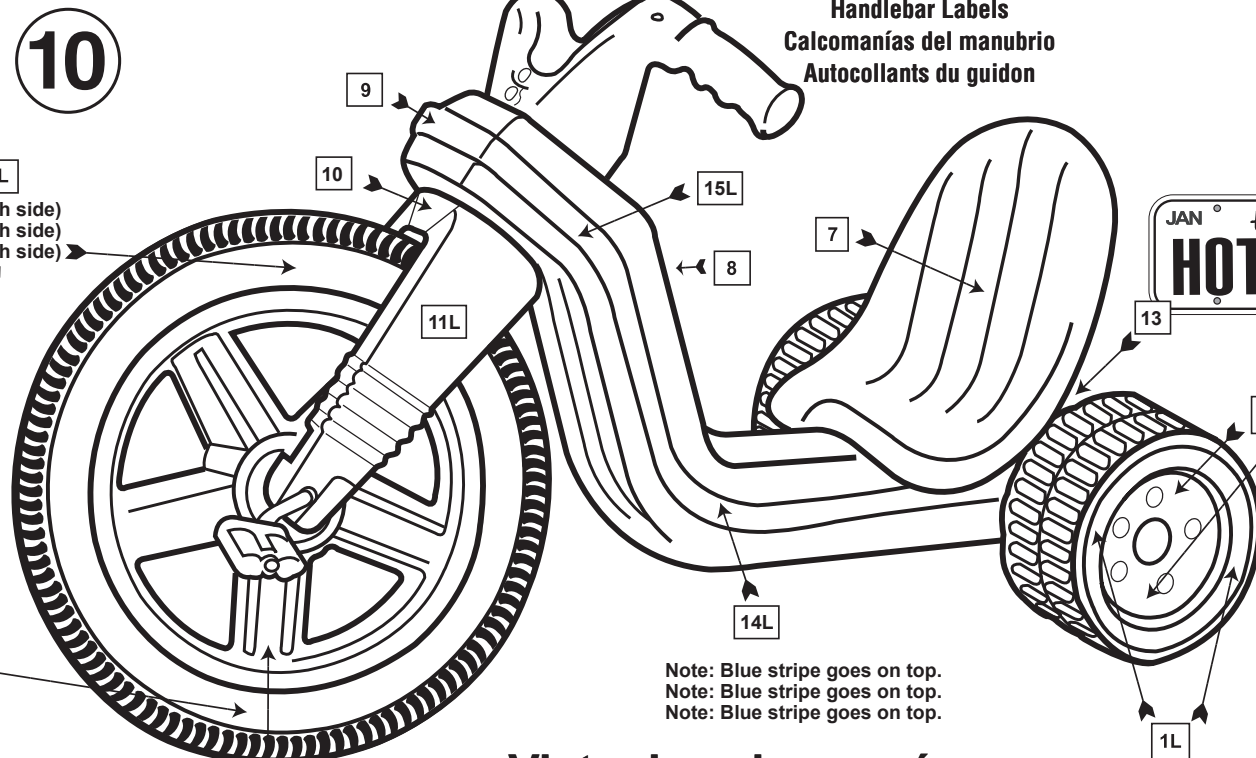
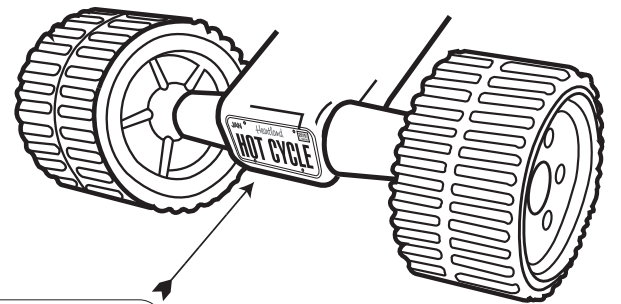

**2L
(2 each side)
(2 each side)
(2 each side)**

**Rear Hub Labels
Rear Hub Labels
Rear Hub Labels**

**12L (2 each side)
12R (2 each side)**

**Note: Blue stripe goes on top.
Note: Blue stripe goes on top.
Note: Blue stripe goes on top.**

Vista de calcomanías

Additionally, refer to photo on box to help place labels.

**5 spoke labels each side
5 spoke labels each side
5 spoke labels each side**

**1L
(2 each side)
(2 each side)**

J. LLOYD
INTERNATIONAL, INC.

Cedar Rapids, IA 52404
www.j-lloyd.com

Customer Service • Service à la clientèle
Servicio Del Cliente:

319-365-5842

Hot Cycle is a trademark
of J. Lloyd International, Inc.
©2010 J. Lloyd International, Inc.
All Rights Reserved.