

89219  
Ages: 3 - 8 years  
Weight Limit: 70 lb (32 kg)

# Minions Racer

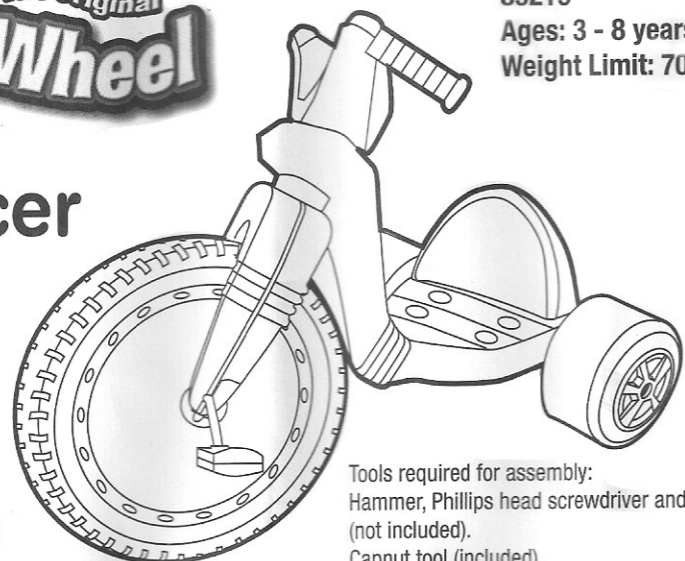

Tools required for assembly:  
Hammer, Phillips head screwdriver and pliers (not included).  
Capnut tool (included).

## 16" Racer Parts List

\* Some extra parts included for convenience.

	Description	QTY
A1&A2	Capnut Tools (dispose when assembly is complete)	2
B	Axle Caps (for rear axle assembly)	2
C	Rear Axle	1
D	Rear Wheels	2
E	Body	1
F	Front Wheel	1
G	Front Wheel Crank Axle	1
H	Front Wheel Drive Inserts	2 sets
I	Fork	1
J	Fork Connectors	2
K	Screws (for fork assembly)	4
L	Locking Star Washers	4
M	Foot Pedals	2
N	Handlebar	1
O	Bolt	1
P	Nut	1
Q	Seat	1
R	Label Sheet	1

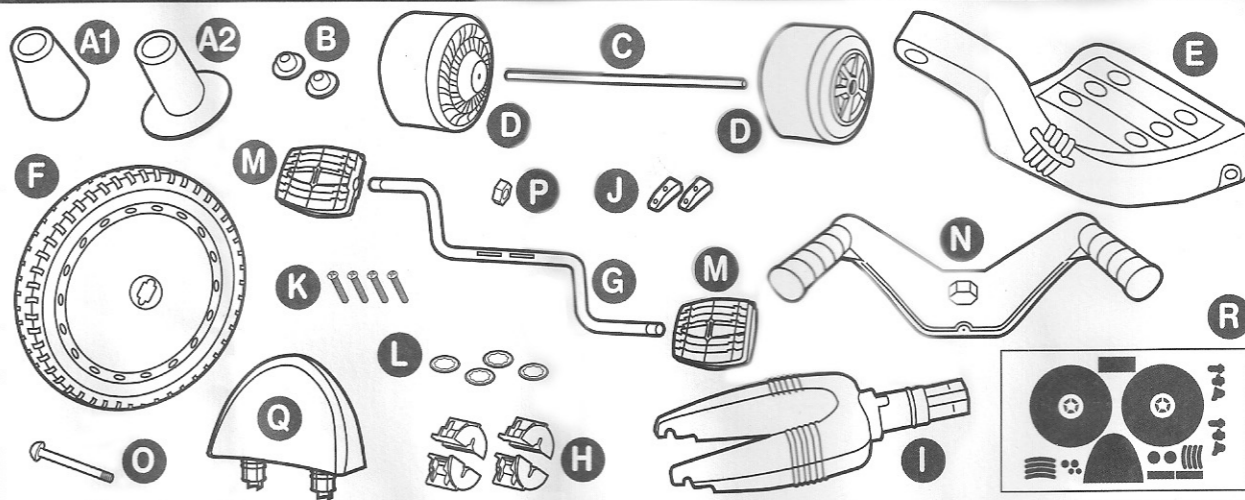

**Note:** Before assembly:  
Remove plastic caps from the Rear Axle and Front Wheel Crank Axle.

**1** Using Capnut Tool **A2** (included), place Axle Cap **B** and Locking Star Washer **L** onto one end of Rear Axle **C** and hammer into place. **Note:** Axle Caps and Locking Star Washers are NOT reusable if removed! Do not put second Axle Cap or Locking Star Washer on until Step 3.

Cupped side "teeth" of Locking Star Washer faces outer to Axle Cap.

**NOTE: Locking Star Washer "teeth" faces down**

**2** Slide one Rear Wheel, Body and second Rear Wheel onto Rear Axle. Pull up on Rear Axle to ensure proper fit.

Inner wheelwall faces body

Capnut Tool keeps Rear Axle Cap End flush with outer wheelwall

**3** Slide second Rear Wheel onto Rear Axle, and attach second Axle Cap and Locking Star Washer to ensure Rear Axle assembly into place.

**Note:** Capnut Tool is needed to ensure axle does not slide down.

Capnut Tool should fit within the recess of the wheel.

Cupped side "teeth" of Locking Star Washer faces outer to Axle Cap.

**4** Apply Labels onto Front Wheel. Insert Front Wheel Crank Axle into Front Wheel.

**5** Place one set of Front Wheel Drive Inserts onto each side of Crank Axle, and insert into Front Wheel. Hold inserts in place and flip over to insert second set of Front Wheel Drive Inserts on opposite side of Front Wheel.

Insert Drive Inserts into Front Wheel

**6** Slide Fork onto Front Wheel assembly and attach Fork Connectors using screws provided (2 screws per side). Repeat on opposite side of Fork.

DO NOT OVER TIGHTEN SCREWS!

**7** Place Locking Star Washer into slot on Foot Pedal (see inset below) and slide Foot Pedal onto end of Front Wheel Crank Axle. Push in to lock in place. Slightly tap Foot Pedal with Hammer to ensure TIGHT fit. Repeat on opposite side.

Cupped side "teeth" of Locking Star Washer faces outer end of Foot Pedal

**8** Insert top end of Fork through neck hole on Body. Place the Handlebar as shown and press down firmly so that the Handlebar goes all the way down onto the top of the Fork. Insert Bolt through Handlebar front. Attach Nut onto Bolt using pliers and tighten using screwdriver.

NUT FACES CHILD SEAT

DO NOT OVER TIGHTEN BOLT!

**9** Place child on Big Wheel™ to determine best seat position for child (3-position options). Push Seat into chosen position all the way down to secure into place.

### Label Placement

(Refer to Step 4)

**WARNING: ADULT ASSEMBLY REQUIRED:**

- Choking hazard to children under the age of 3 years - contains small parts prior to assembly.
- Product contains small parts with potentially sharp points and edges.
- Keep away from children prior to assembly.
- Conforms to safety requirements of ASTM F963 and ANSI Z315.1
- Hammer and Phillips head screwdriver required for assembly. Net Quantity: 1

**WARNING: TO AVOID SERIOUS INJURY:**

- Continuous adult supervision required.
- Never use near motor vehicles.
- Never use near streets, swimming pools, hills, steps or sloped driveways.
- Always wear shoes when using the tricycle.
- Never allow more than 1 rider.
- Conduct periodic inspection of hardware and proper maintenance of the unit.
- Always wear a properly fitted helmet that complies with U.S. Consumer Product Safety Commission (CPS) standards. 16 CFR 1203. (Helmet not included).

UNIVERSAL. [minionsmovie.com](http://minionsmovie.com) #minions  
Minions is a trademark and copyright of Universal Studios. Licensed by Universal Studios Licensing LLC. All rights reserved.

ILLUMINATION ENTERTAINMENT

TM & © 2015 KIDS ONLY, LTD.  
(A SUBSIDIARY OF JAKKS PACIFIC, INC.)  
92 GRANVILLE ROAD, KOWLOON, HONG KONG.  
© 2015 ALPHA INTERNATIONAL, INC.  
BIG WHEEL IS A TRADEMARK OF ALPHA INTERNATIONAL, INC.  
COLORS AND STYLES MAY VARY DUE TO CONSTANT IMPROVEMENTS.  
ALL RIGHTS RESERVED.  
[WWW.KIDSONLYTOYS.COM](http://WWW.KIDSONLYTOYS.COM)  
MADE IN CHINA.

FOR QUESTIONS PLEASE CALL: 1-877-875-2557

Pub. Date: 10/06/2015