

#48105 & #48106

Hammer and Phillips head screwdriver required for assembly.
Rev. 2.1

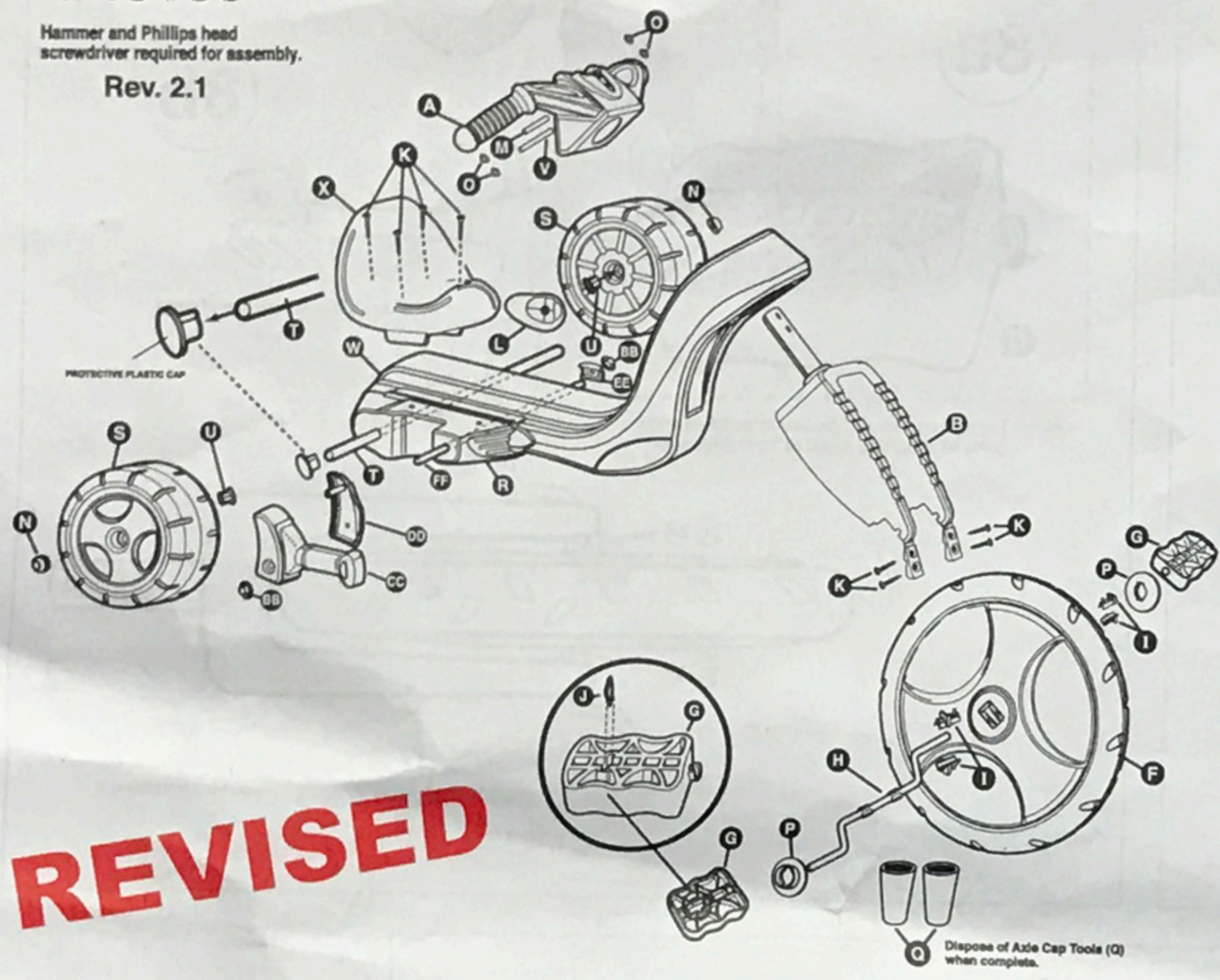

REVISED

FOR QUESTIONS PLEASE CALL:
508-836-8697

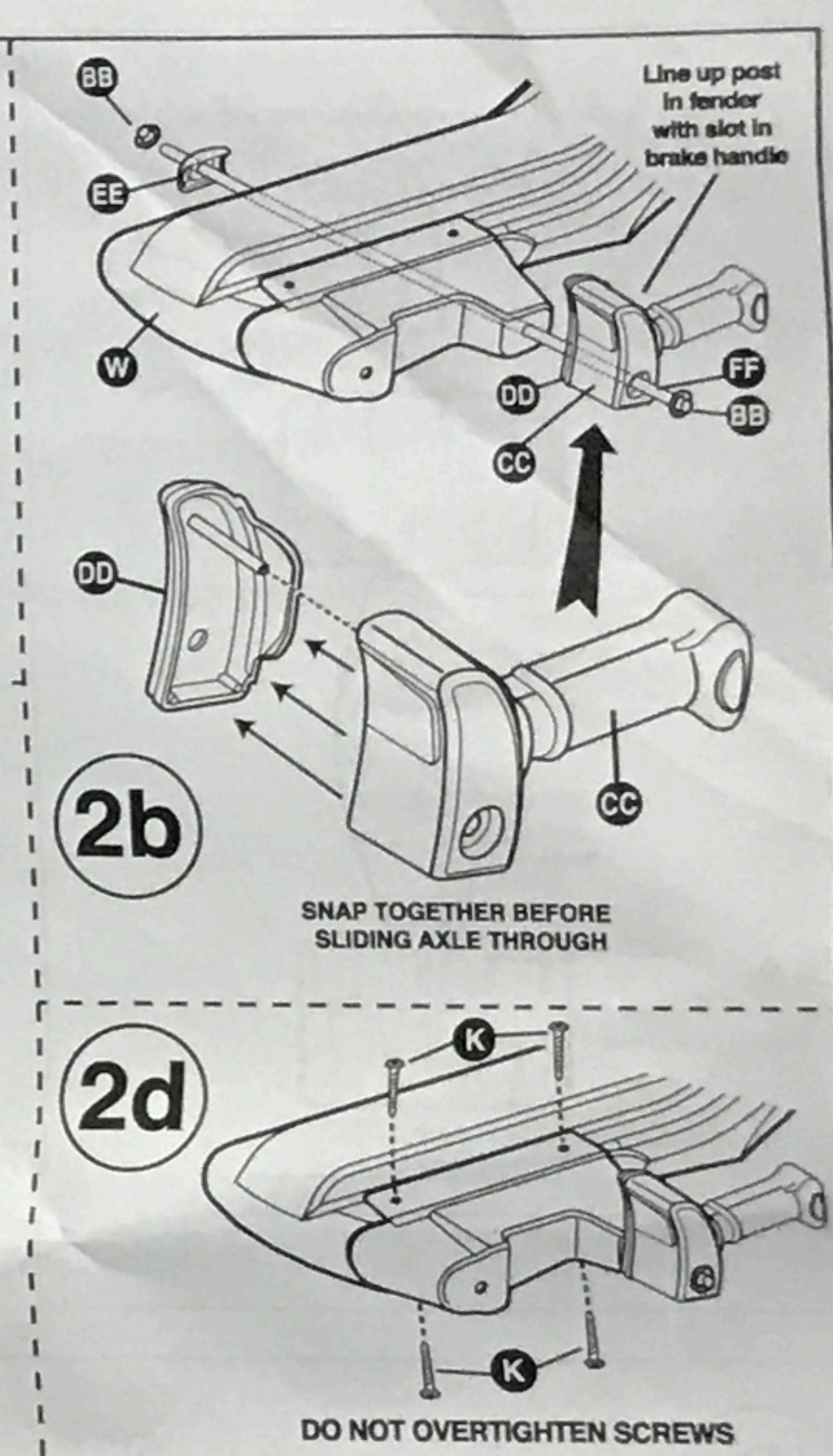
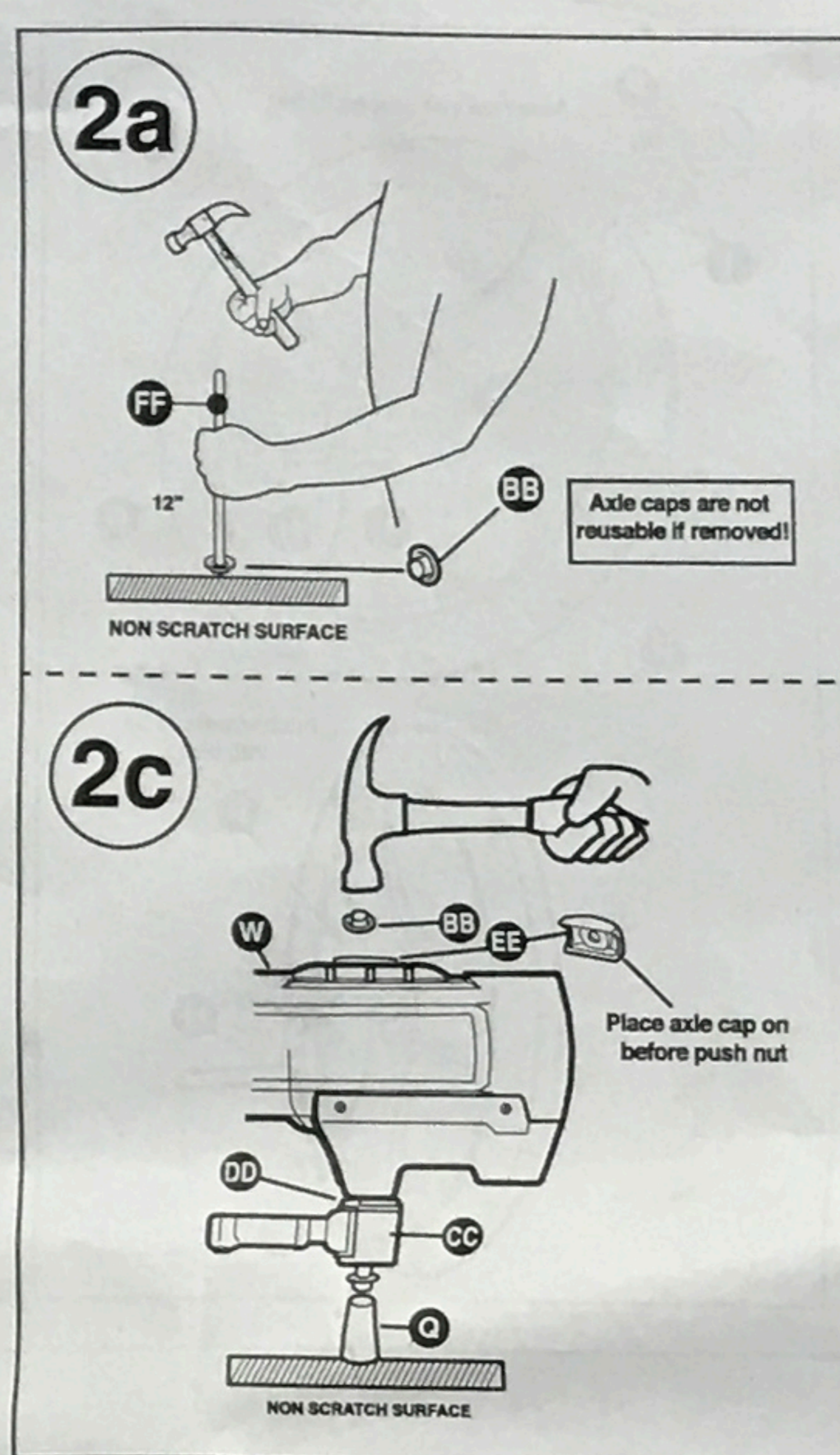
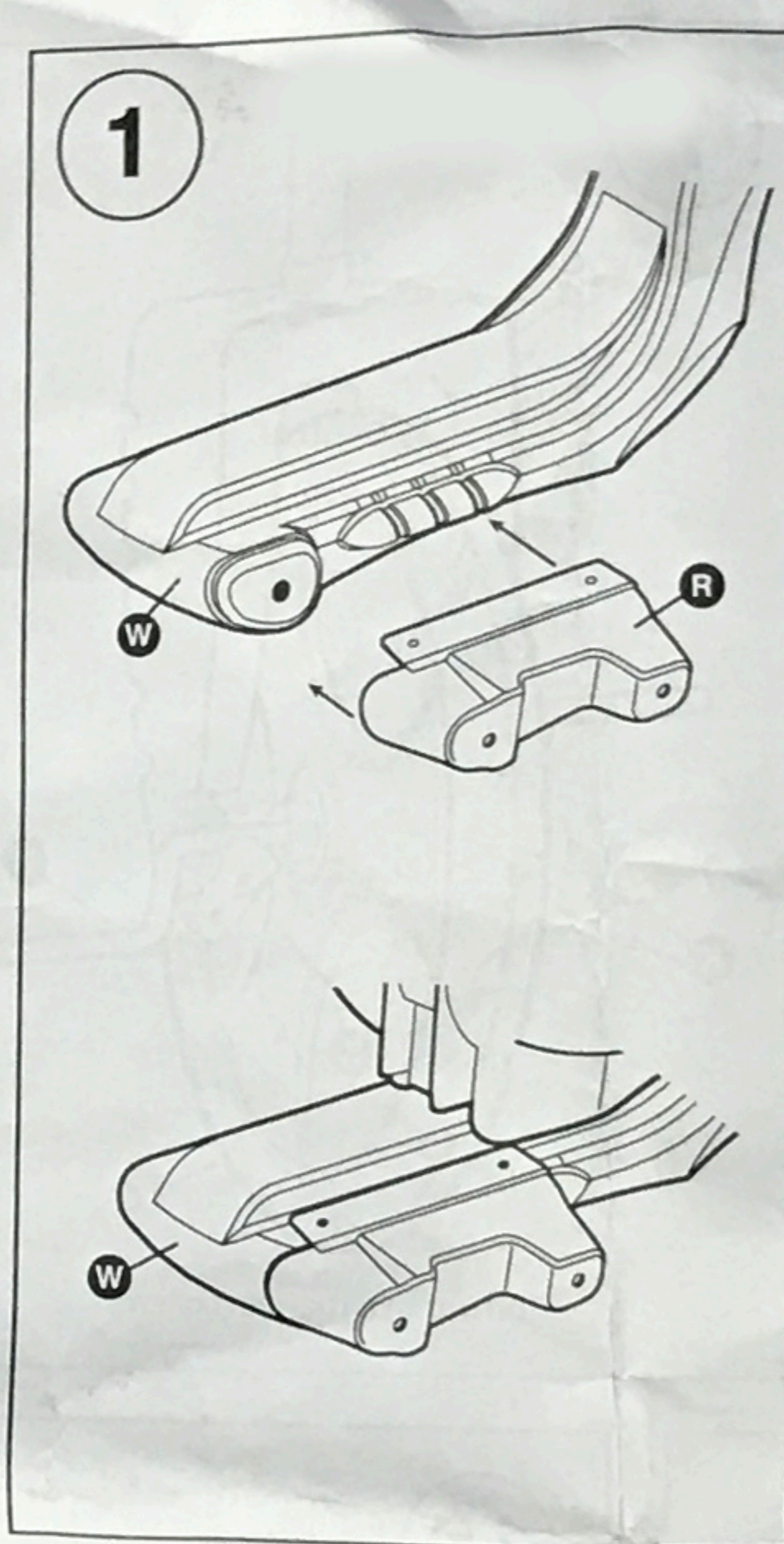

REMOVE PROTECTIVE PLASTIC CAPS FROM AXLE ENDS AND DISPOSE OF.

TRIKE PARTS LIST					
#	DESCRIPTION	QTY	#	DESCRIPTION	QTY
A	HANDLEBAR	1	Q	CAPNUT TOOLS	2
B	FORK	1	R	RIGHT FENDER	1
C	PLASTIC WASHERS	4	S	REAR WHEELS	2
F	FRONT WHEEL	1	T	21" REAR WHEEL AXLE	1
G	PEDALS	2	U	PLASTIC BUSHING	2
H	FRONT DRIVE AXLE	1	V	3" STEEL ROD	1
I	FRONT AXLE SPACERS	4	W	BODY	1
J	TINNERMAN® (IN PEDALS)	2	X	SEAT	1
K	3/4" SCREWS	12	AA	LABEL SHEET	1
L	LEFT FENDER	1	BB	5/8" AXLE CAP	2
M	2 1/4" STEEL ROD	1	CC	BRAKE HANDLE	1
N	3/8" PUSHNUT	2	DD	BRAKE HANDLE BACK	1
O	1/4" CAP NUTS	4	EE	BRAKE AXLE CAP	1
P	WHEEL COLLAR	2	FF	12" BRAKE AXLE	1

The Original Big Wheel

WARNING: TO AVOID SERIOUS INJURY: Continuous adult supervision required. Never use near motor vehicles. Never use near streets, swimming pools, hills, slopes or sloped driveways. Always wear shoes when using the tricycle. Allow only one rider. Conduct periodic inspection of hardware and proper maintenance of the unit. Always wear a properly fitted helmet that complies with U.S. Consumer Product Safety Commission (CPSC) standards. 16 CFR 1203. (Helmet Not Included).

WARNING: ADULT ASSEMBLY REQUIRED. Product contains small parts with potentially sharp points and edges. Keep away from children prior to assembly.

Conforms to safety requirements of ASTM F963 and ANSI Z315.1
Hammer and Phillips head screwdriver required for assembly. Net Quantity: 1

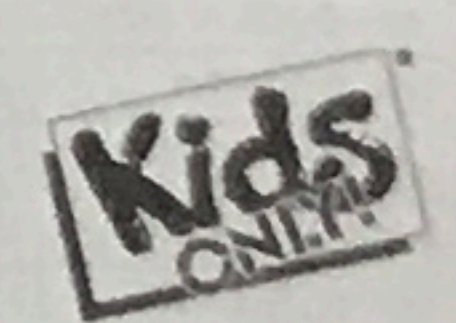
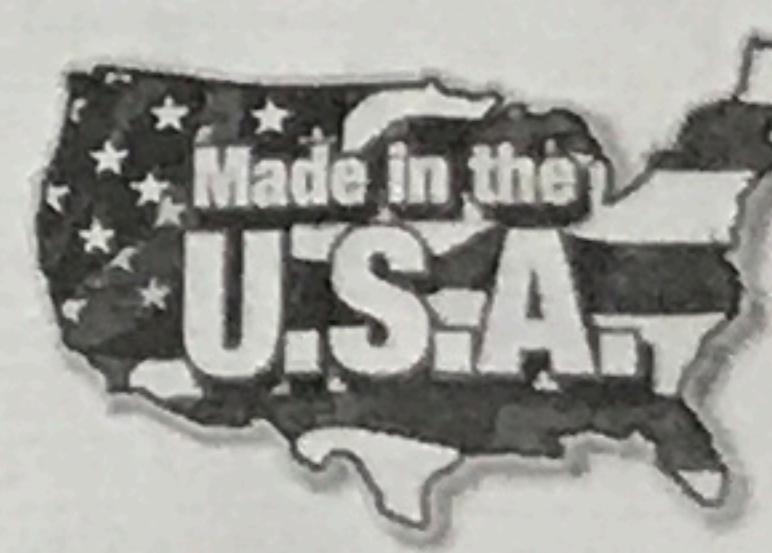
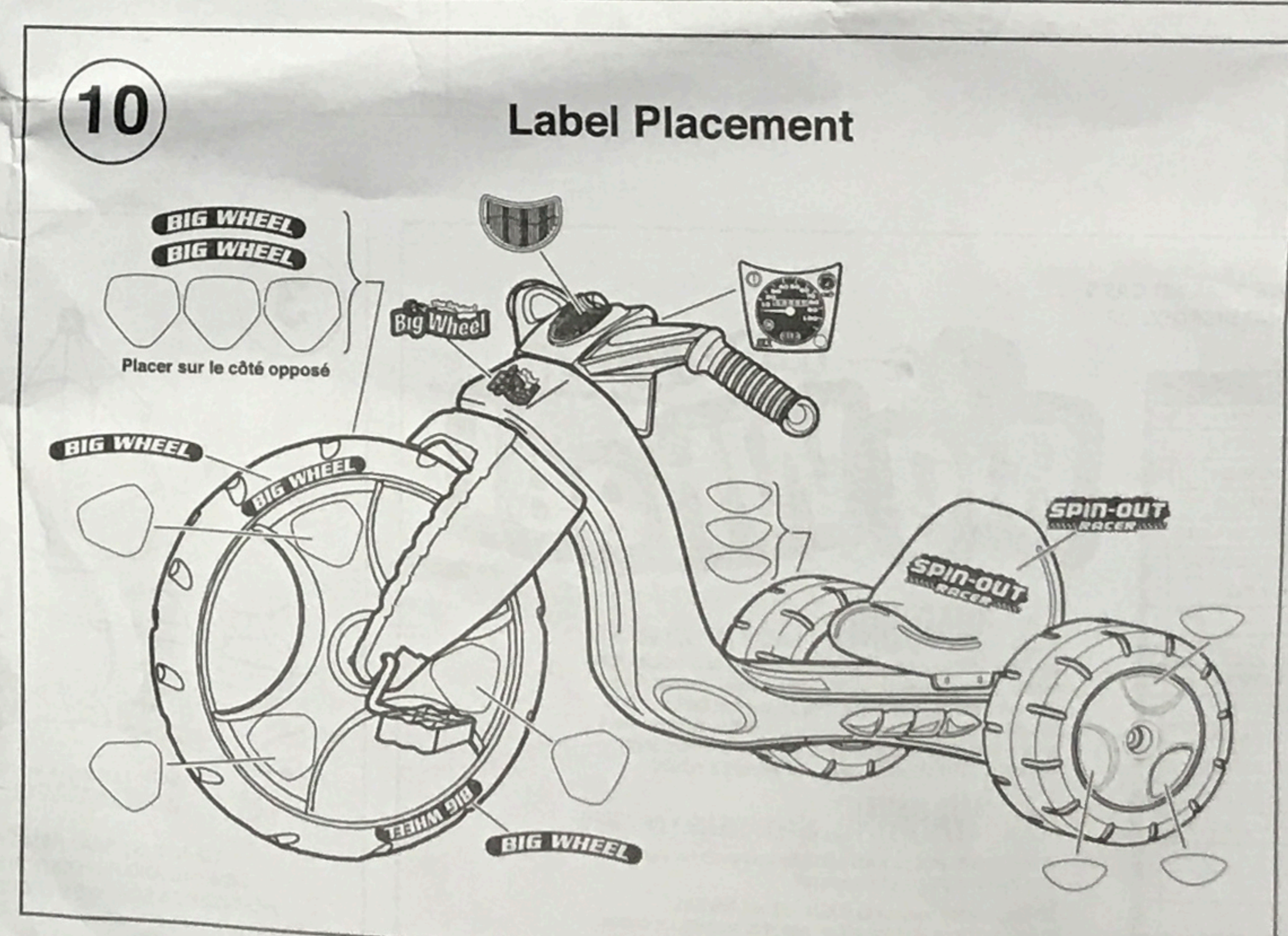
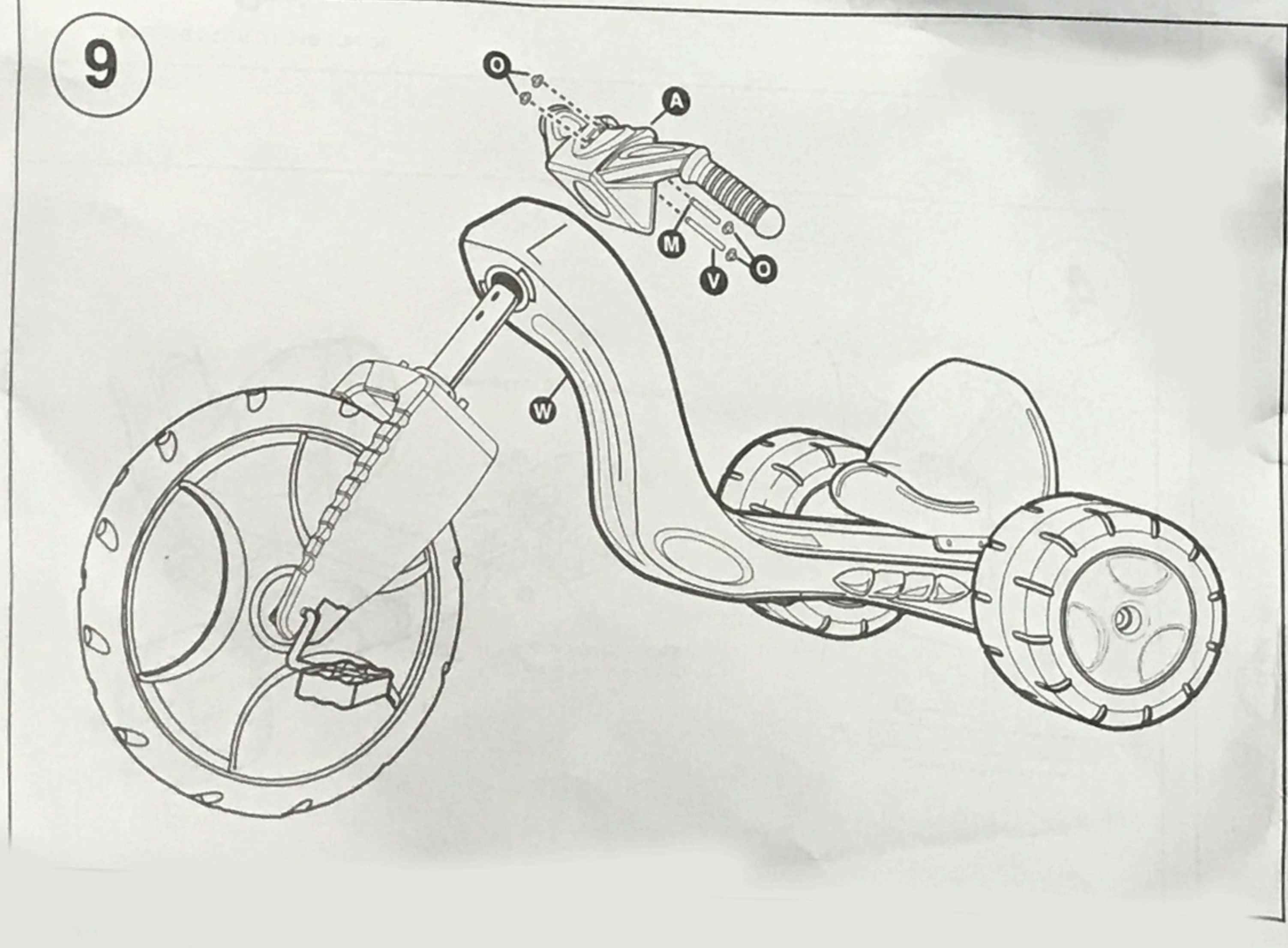
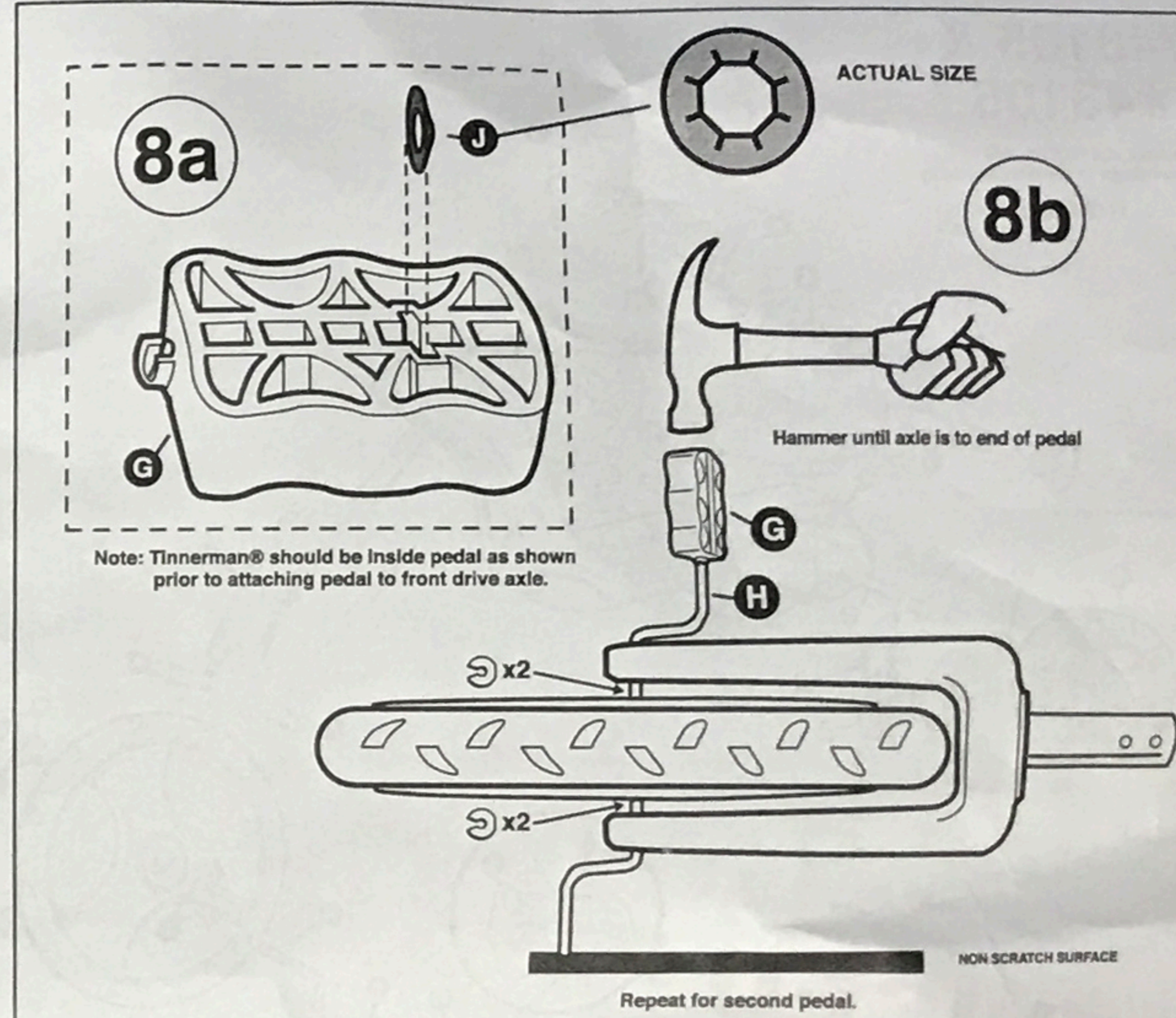
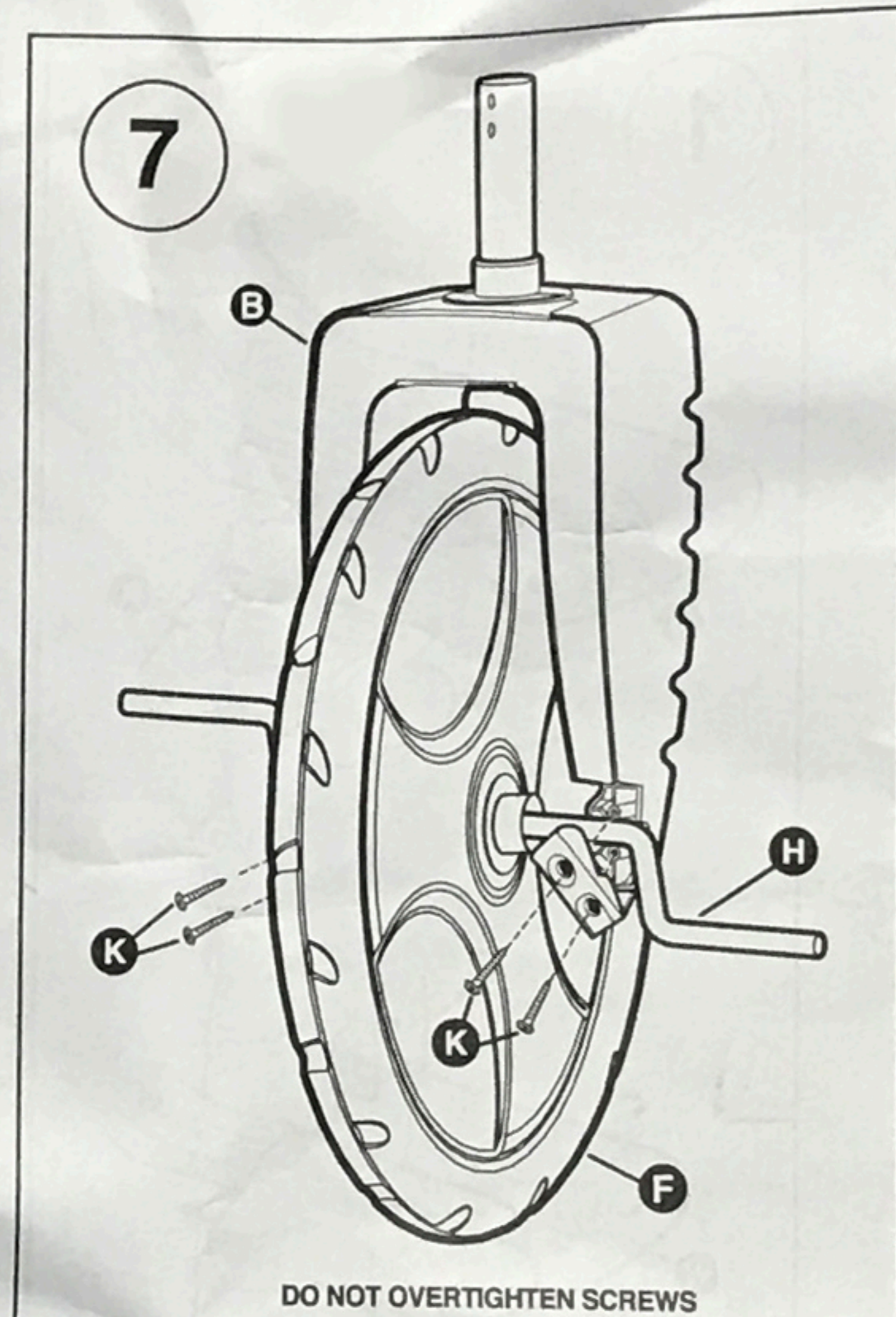
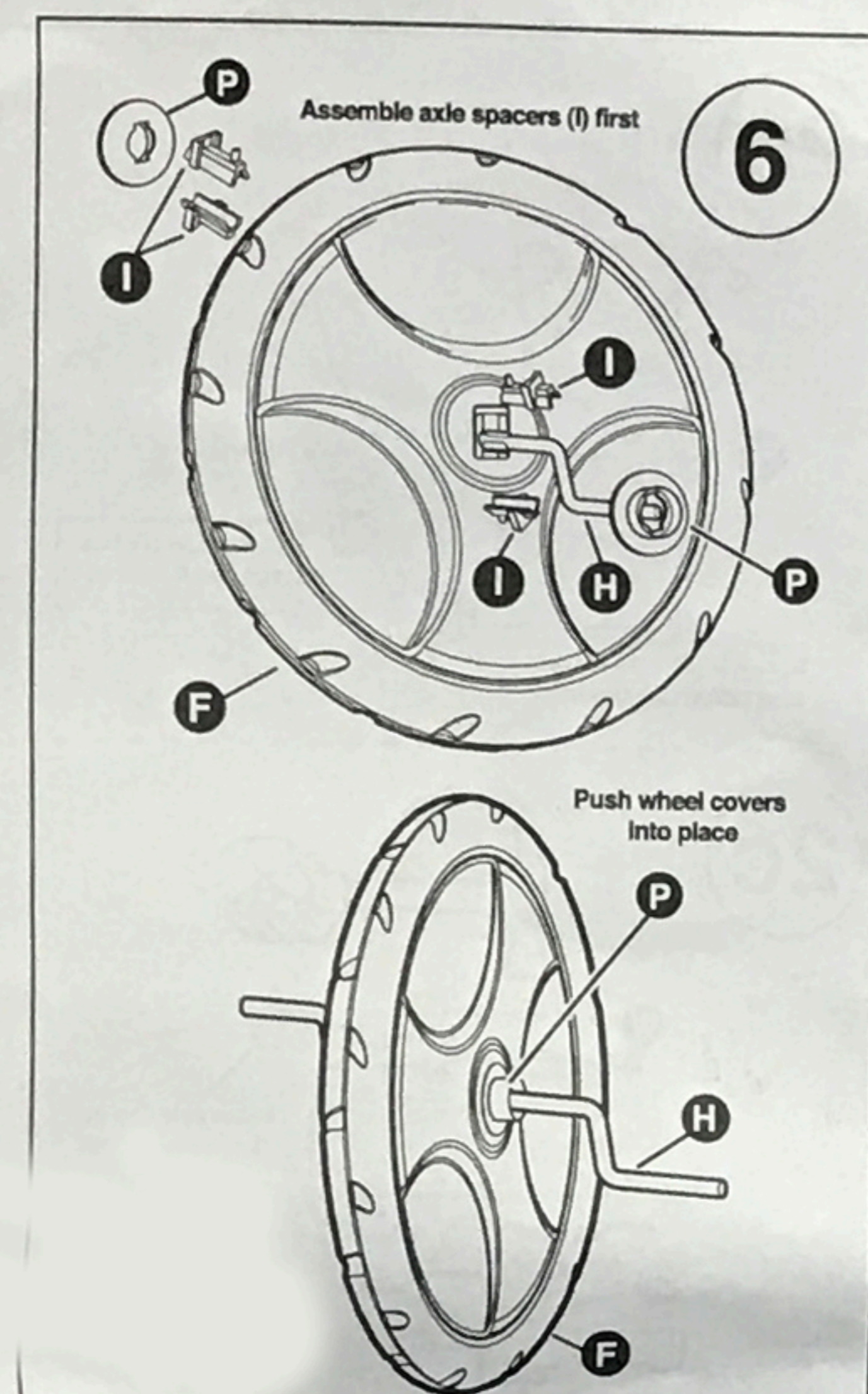
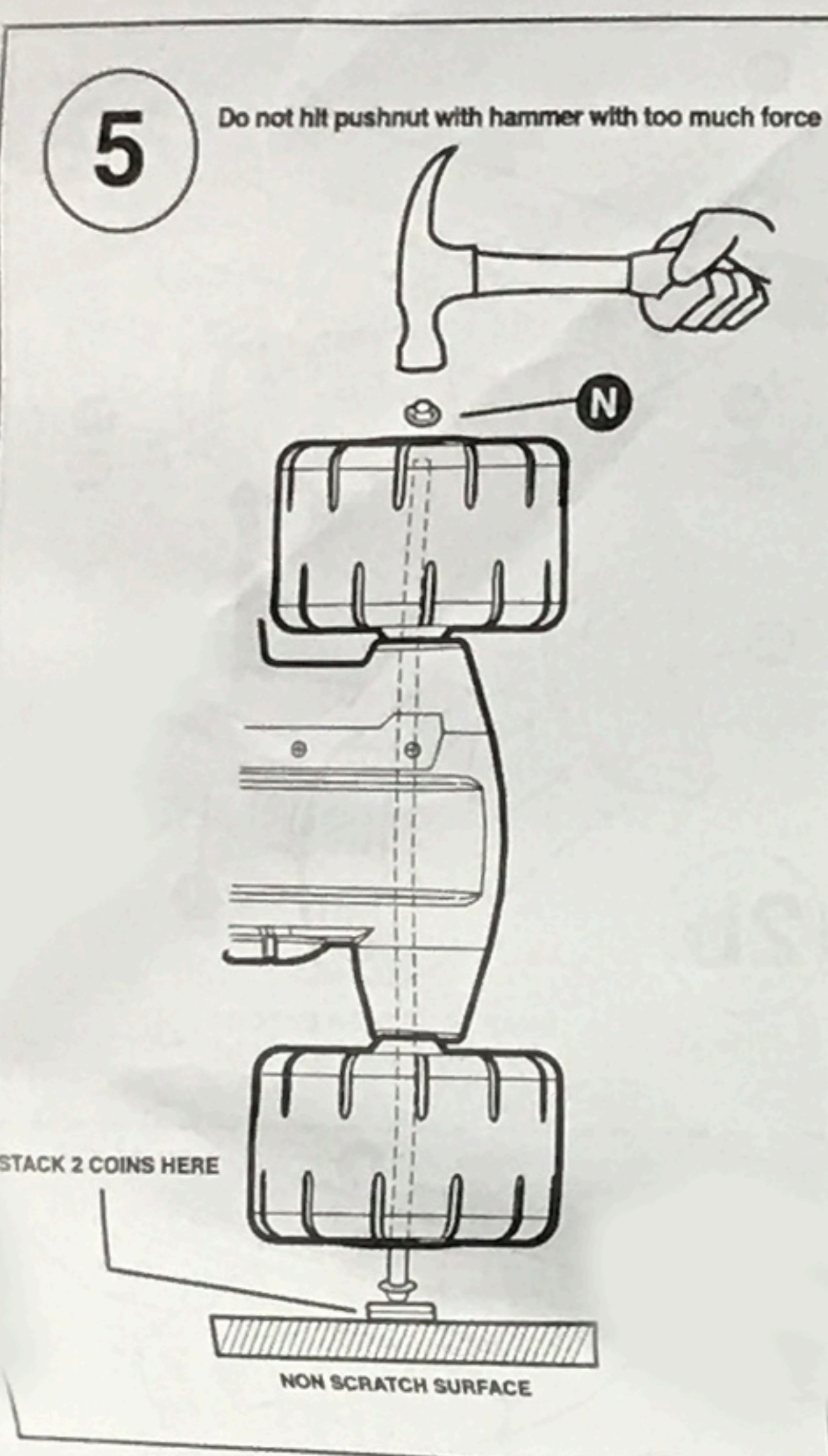
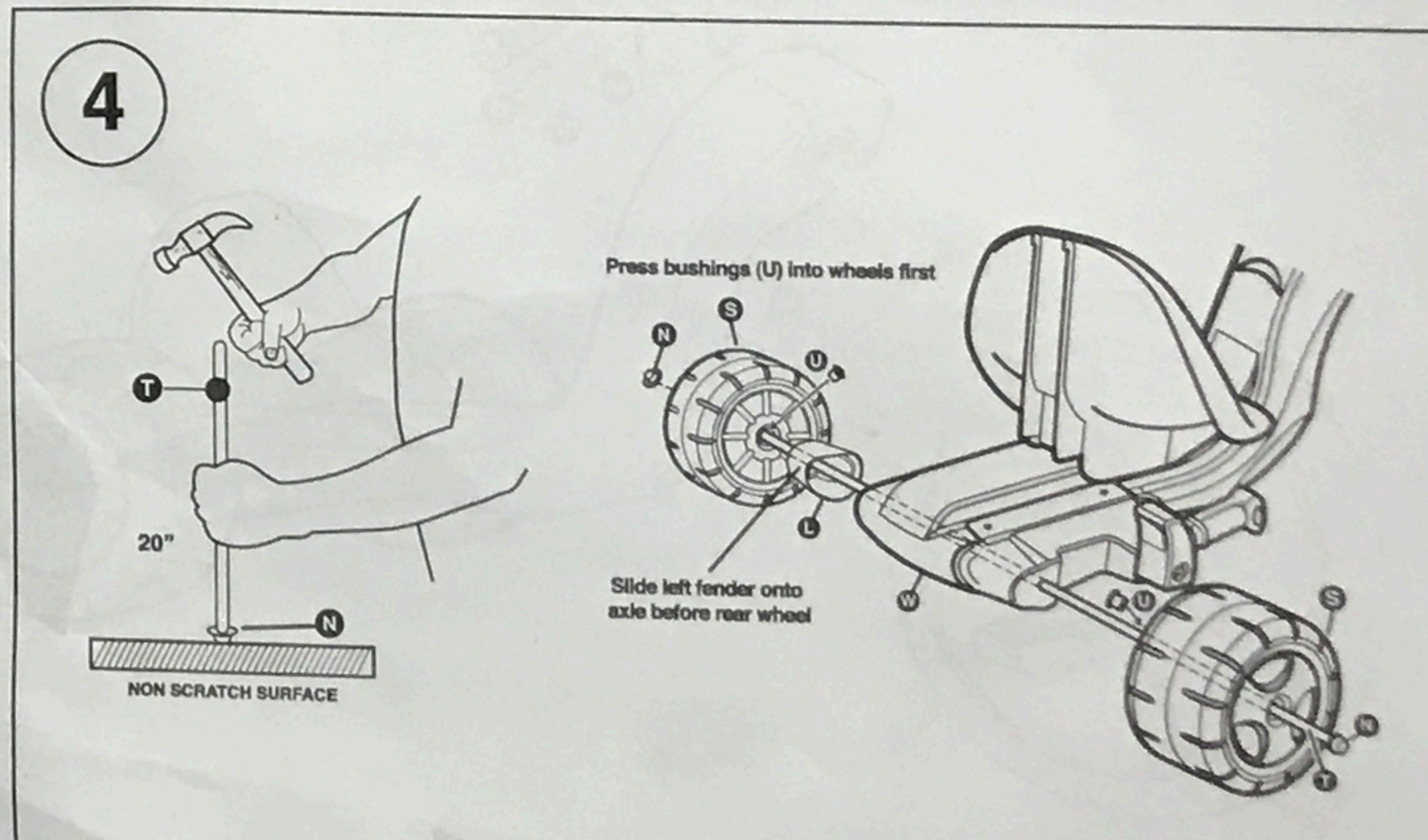
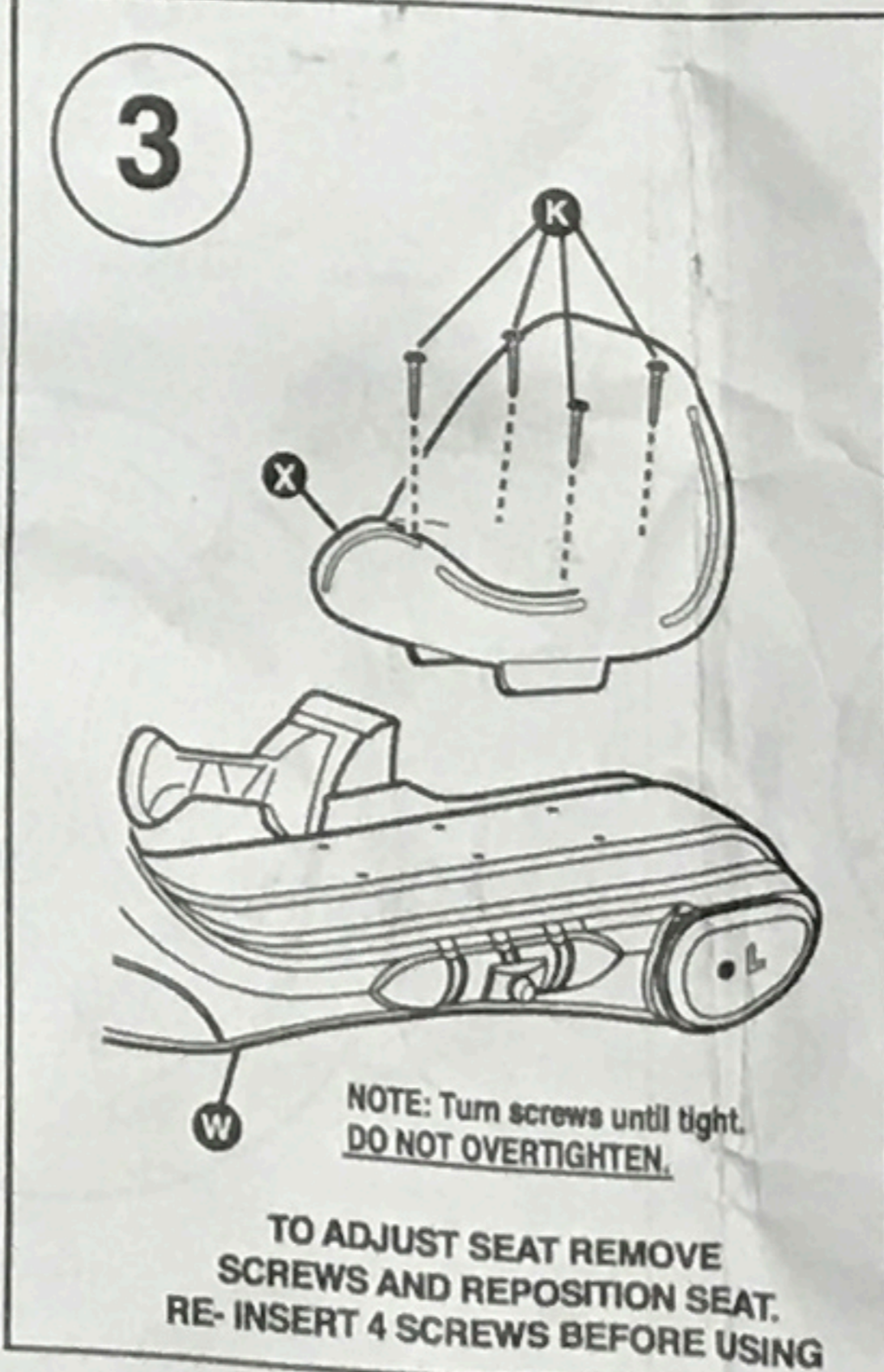

© 2012 Alpha International, Inc.
© 2012 Distributed by Kids Only, Inc.
11A Walkup Drive, Westboro, MA 01581
All Rights Reserved
Colors & Style May Vary Due to Constant Improvement
MADE AND PRINTED IN U.S.A.
www.kidsonlytoys.com