



TRIKE PARTS LIST					
#	DESCRIPTION	QTY	#	DESCRIPTION	QTY
A	HANDLEBAR	1	I	3/8" CAPNUT (METAL)	2
B	FORK	1	J	CAPNUT TOOLS	2
C	FORK CAP	2	K	BODY	1
D	DRIVE INSERT	4	L	5/16" WASHER	2
E	FRONT WHEEL	1	M	1" SCREWS	6
F	PEDALS	2	N	REAR WHEELS	2
G	FRONT DRIVE AXLE	1	O	REAR AXLE	1
H	5/16" CAPNUT (METAL)	2	P	LABEL SHEET	1

LISTE DES PIÈCES DU TRICYCLE					
#	DESCRIPTION	QTY	#	DESCRIPTION	QTY
A	GUIDON	1	I	ÉCROU D'ARRÊT 3/8"(MÉTAL)	2
B	FOURCHE	1	J	OUTILS D'ÉCROU	2
C	BOUCHON DE FOURCHE	2	K	CHÂSSIS	1
D	RACCORD DE COMMANDE	4	L	RONDELLE DE 5/16 PO	2
E	ROUE AVANT	1	M	VIS 1"	6
F	PÉDALES	2	N	ROUES ARRIÈRE	2
G	ESSIEU AVANT	1	O	ESSIEU ARRIÈRE	1
H	ÉCROU D'ARRÊT 5/16"(MÉTAL)	2	P	FEUILLE D'ÉTIQUETTES	1

LISTA DE PARTES DEL TRICICLO					
#	DESCRIPCIÓN	CAN	#	DESCRIPCIÓN	CAN
A	MANILLARES	1	I	3/8" TUERCA DE FIJACIÓN	2
B	HORQUILLA	1	J	SOPORTE DE LA TUERCA DE PRESION	2
C	TAPA DE LA HORQUILLA	2	K	CUERPO	1
D	INTRODUCTOR DE TRACCION	4	L	RONDANA DE 5/16"	2
E	RUEDA DELANTERA	1	M	TORNILLOS DE 1"	6
F	PEDALES	2	N	RUEDAS TRASERAS	2
G	EJE DELANTERO	1	O	EJE TRASERO	1
H	5/16" TUERCA DE FIJACIÓN	2	P	HOJA DE ESTAMPAS	1



Maximum Weight: 45 lbs. (20.4kg).
Poids maximal: 20,4 kg (45 lb).
Peso Máximo: 45 lbs. (20.4 kg).

Remove and properly dispose of axle guards. They are not part of this toy!
Saque y bote los guardaejes. Estos no forman parte del juguete.
Retirez et disposez convenablement des protecteurs d'essieu; ces pièces ne font pas partie du jouet.

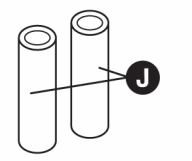
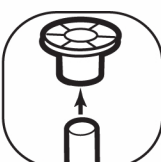

Dispose of Capnut Tools (J) when complete.
Jeter les outils d'écrou (J) après usage.
Tire las herramientas de tuerca de fijación (J) cuando terminado.

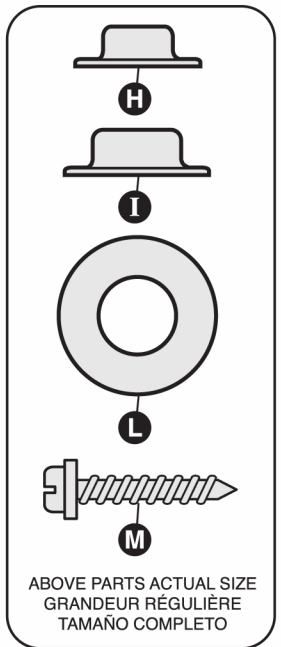
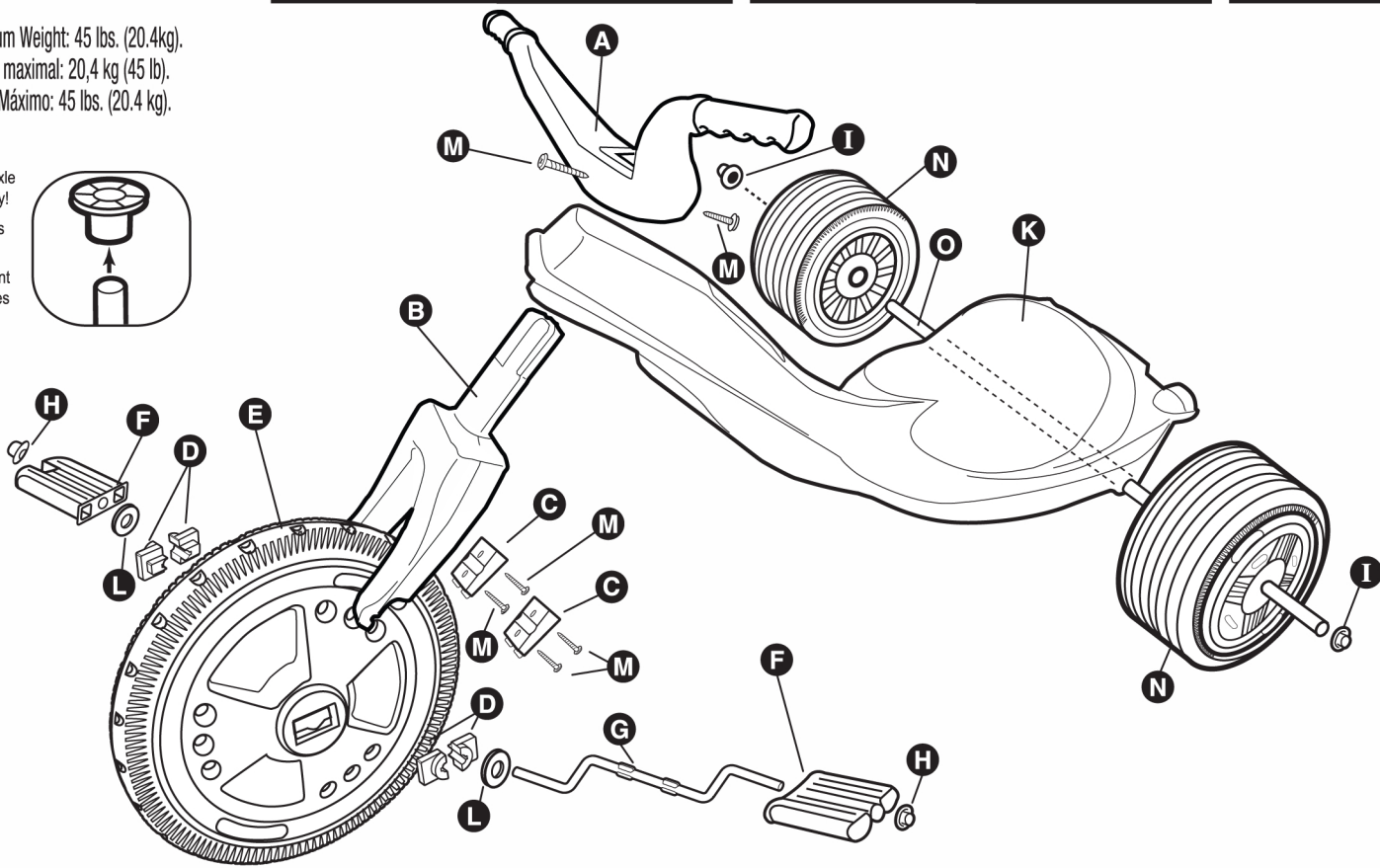

ABOVE PARTS ACTUAL SIZE
GRANDEUR RÉGULIÈRE
TAMAÑO COMPLETO

READ ALL INSTRUCTIONS BEFORE BEGINNING ASSEMBLY

WARNING: CHOKING HAZARD-Small Parts
PUNCTURE HAZARD-Sharp Points
Keep screws away from small children.
Adult Assembly Required.

WARNING: TO AVOID SERIOUS INJURY:
Continuous adult supervision required; never use near steps, sloped driveways, hills, roadways, alleys nor near motor vehicles; swimming pool areas; always wear shoes, and never allow more than one rider.
Please inspect the rider for loose or damaged parts, monthly.

- TOOLS REQUIRED**
- HAMMER
 - PHILLIPS HEAD SCREWDRIVER
 - CAPNUT TOOL (SUPPLIED)
 - WOOD BLOCK (OR OTHER HARD OBJECT)

INSTRUCTIONS:
Remove and identify all parts from carton and properly dispose of all packing materials.

CAUTION: Do NOT install both pedals to the pedal crank axle until pedal crank axle is pushed through wheel!

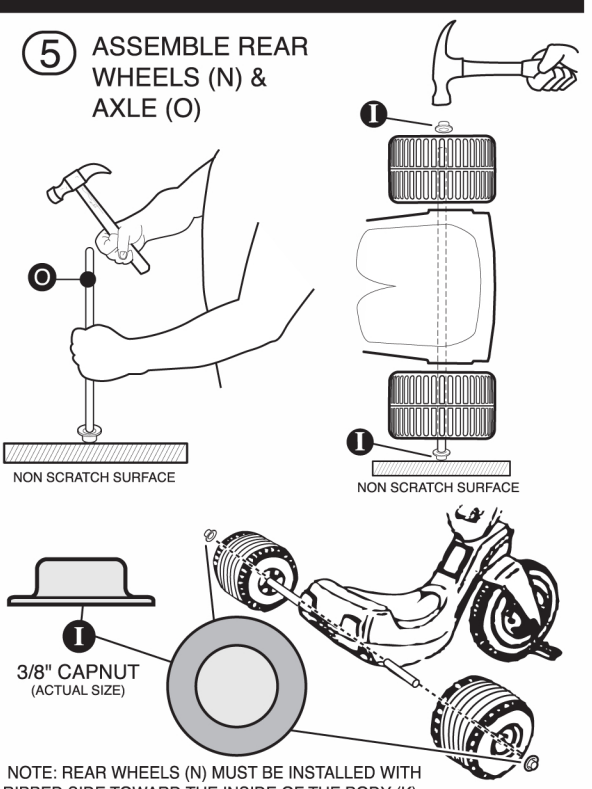
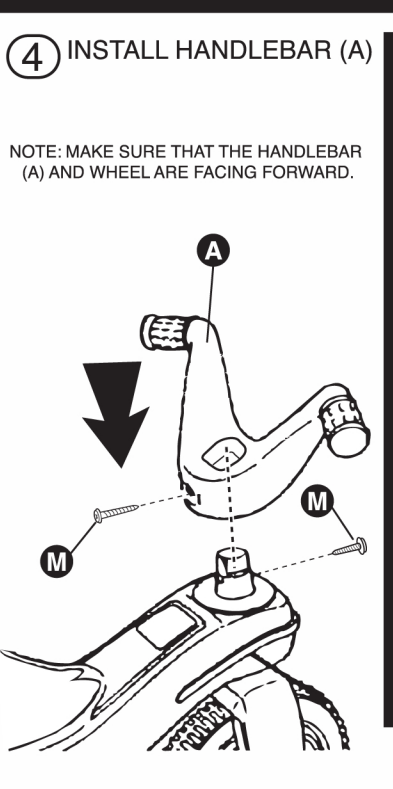
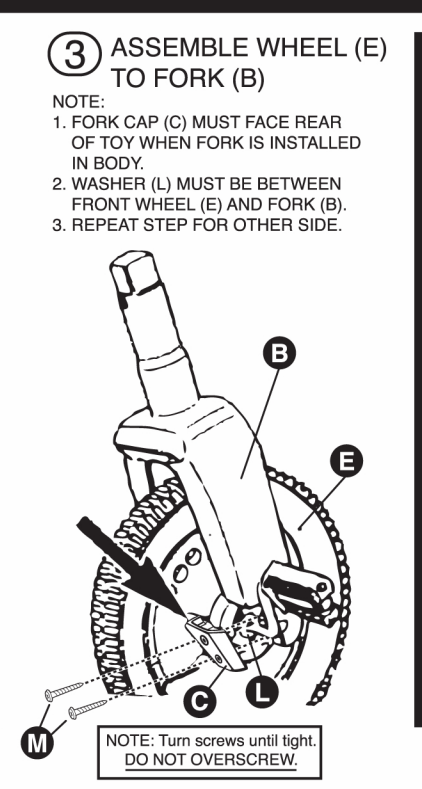
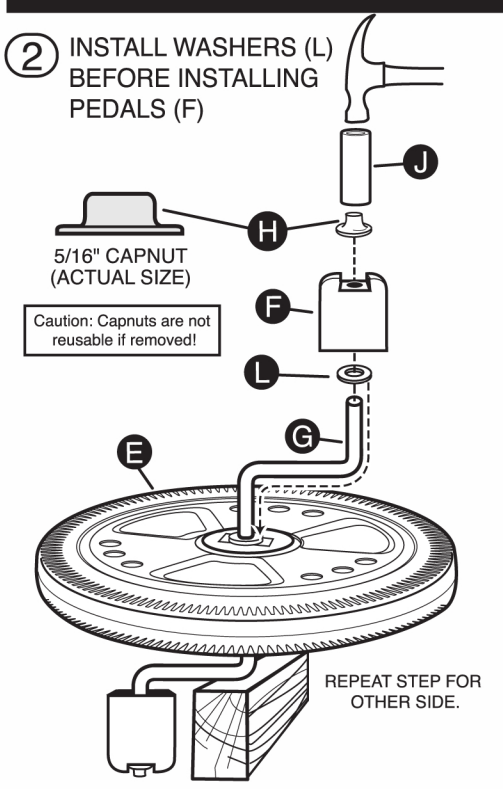
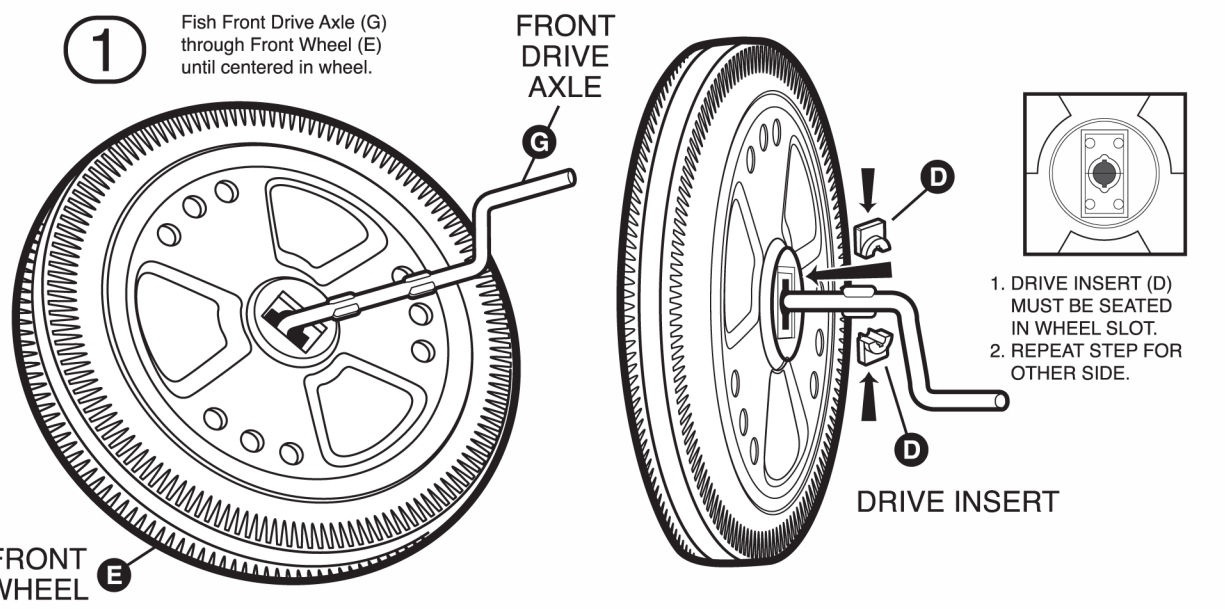

**Label Placement / Colocacion de Etiqueta
Position des autocollants**

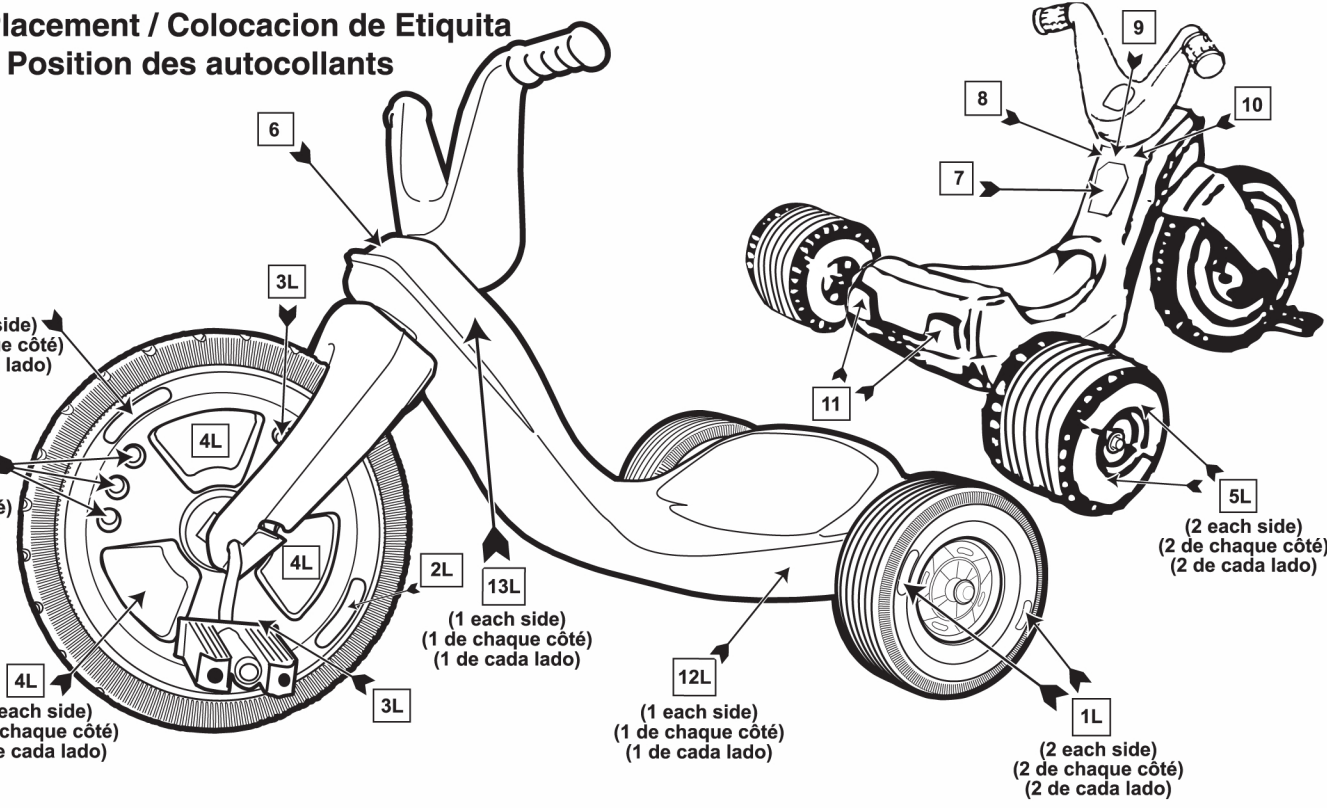

J.LLOYD
INTERNATIONAL, INC.
Cedar Rapids, IA 52404

Big Wheel is a registered trademark of Alpha International, Inc.
Big Wheel est une marque de commerce de Alpha International, Inc.
Big Wheel es una marca registrada de Alpha International, Inc.

©2010 Alpha International, Inc.
All Rights Reserved./Tous droits réservés.
Todos los derechos son reservados.

Customer Service • Service à la clientèle
Servicio Del Cliente:
319-365-5842
www.originalbigwheel.com