



No. 69055 - 69056  
ver, 2 (10/19)

TRIKE PARTS LIST				
#	DESCRIPTION	QTY	# DESCRIPTION	QTY
A	HANDLEBAR	1	I 3/8" CAPNUT (METAL)	2
B	FORK	1	J CAPNUT TOOLS	2
C	FORK CAP	2	K BODY	1
D	DRIVE INSERT	2	L 5/16" WASHER	2
E	FRONT WHEEL	1	M 1" SCREWS	4
F	PEDALS	2	N REAR WHEELS	2
G	FRONT DRIVE AXLE	1	O REAR AXLE	1
H	TINNERMAN WASHER	2	P LABEL SHEET	1
			Q 1/4" X 3,1/8" BOLT	1
			R 1/4" LOCK NUT	1

LISTE DES PIÈCES DU TRICYCLE				
#	DESCRIPTION	QTY	# DESCRIPTION	QTY
A	GUIDON	1	I ÉCROU D'ARRÊT 3/8"(MÉTAL)	2
B	FOURCHE	1	J OUTILS D'ÉCROU	2
C	BOUCHON DE FOURCHE	2	K CHÂSSIS	1
D	RACCORD DE COMMANDE	2	L RONDELLE DE 5/16 PO	2
E	ROUE AVANT	1	M VIS 1"	4
F	PÉDALES	2	N ROUES ARRIÈRE	2
G	ESSIEU AVANT	1	O ESSIEU ARRIÈRE	1
H	TINNERMAN 1/2"(RONDELLE)	2	P FEUILLE D'ÉTIQUETTES	1
			Q 1/4" X 3,1/8" BOULON	1
			R 1/4" NOIX DE CAJOU	1

LISTA DE PARTES DEL TRICICLO				
#	DESCRIPCIÓN	CAN	# DESCRIPCIÓN	CAN
A	MANILLARES	1	I 3/8" TUERCA DE FIJACIÓN	2
B	HORQUILLA	1	J SOPORTE DE LA TUERCA DE PRESION	2
C	TAPA DE LA HORQUILLA	2	K CUERPO	1
D	INTRODUCOR DE TRACCION	2	L RONDANA DE 5/16"	2
E	RUEDA DELANTERA	1	M TORNILLOS DE 1"	4
F	PEDALES	2	N RUEDAS TRASERAS	2
G	EJE DELANTERO	1	O EJE TRASERO	1
H	1/2" TINNERMAN ARANDELAS	2	P HOJA DE ESTAMPAS	1
			Q 1/4" X 3,1/8" TORNILLO	1
			R 1/4" TUERCA DE BLOQUEO	1



Maximum Weight: 45 lbs. (20.4kg).  
Poids maximal: 20,4 kg (45 lb).  
Peso Máximo: 45 lbs. (20.4 kg).

Remove and properly dispose of axle guards. They are not part of this toy!  
Saque y bote los guardaejes. Estos no forman parte del juguete.  
Retirez et disposez convenablement des protecteurs d'essieu; ces pieces ne font pas partie du jouet.

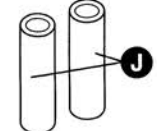
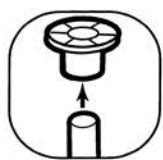

Dispose of Capnut Tools (J) when complete.  
Jeter les outils d'écrou (J) après usage.  
Tira las herramientas de tuerca de fijación (J) cuando terminado.

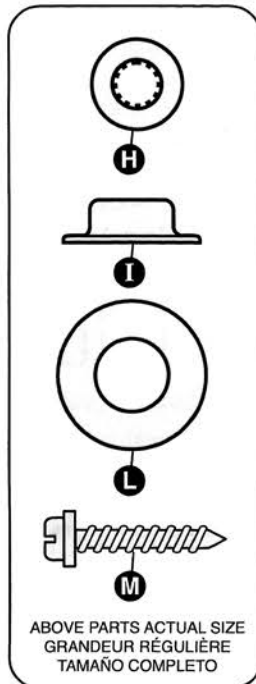
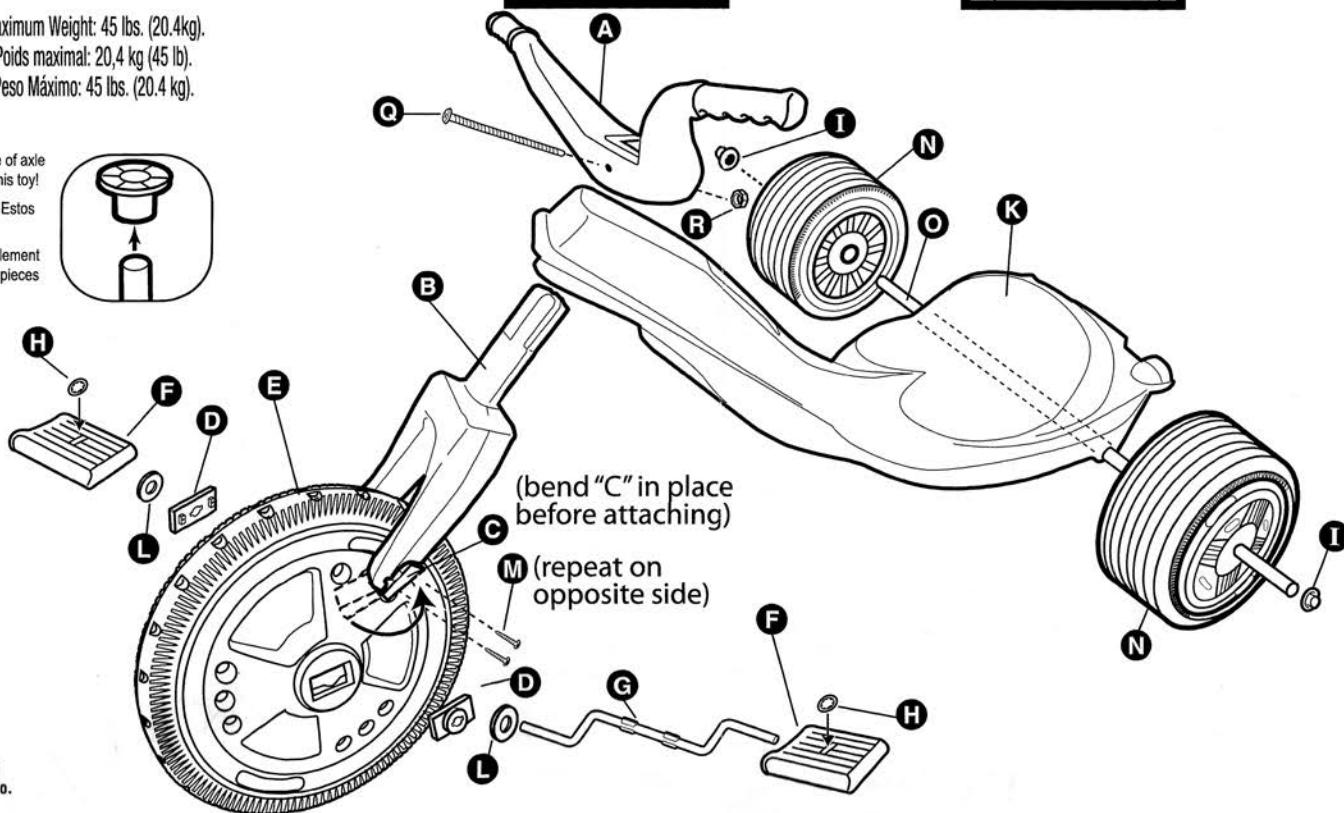

ABOVE PARTS ACTUAL SIZE  
GRANDEUR RÉGULIÈRE  
TAMAÑO COMPLETO

**READ ALL INSTRUCTIONS BEFORE BEGINNING ASSEMBLY**

**WARNING:**  
CHOKING HAZARD-Small Parts  
PUNCTURE HAZARD-Sharp Points  
Keep screws away from small children.  
Adult Assembly Required.

**WARNING: TO AVOID SERIOUS INJURY:**  
Continuous adult supervision required; never use near steps, sloped driveways, hills, roadways, alleys nor near motor vehicles; swimming pool areas; always wear shoes, and never allow more than one rider.  
Please inspect the rider for loose or damaged parts, monthly.

**TOOLS REQUIRED**

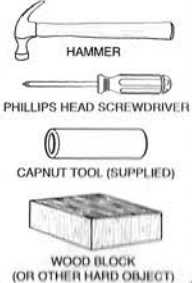

**INSTRUCTIONS:**

Remove and identify all parts from carton and properly dispose of all packing materials.

**CAUTION:** Do NOT install both pedals to the pedal crank axle until pedal crank axle is pushed through wheel!

**1**

Fish Front Drive Axle (G) through Front Wheel (E) until centered in wheel.

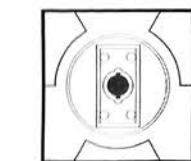
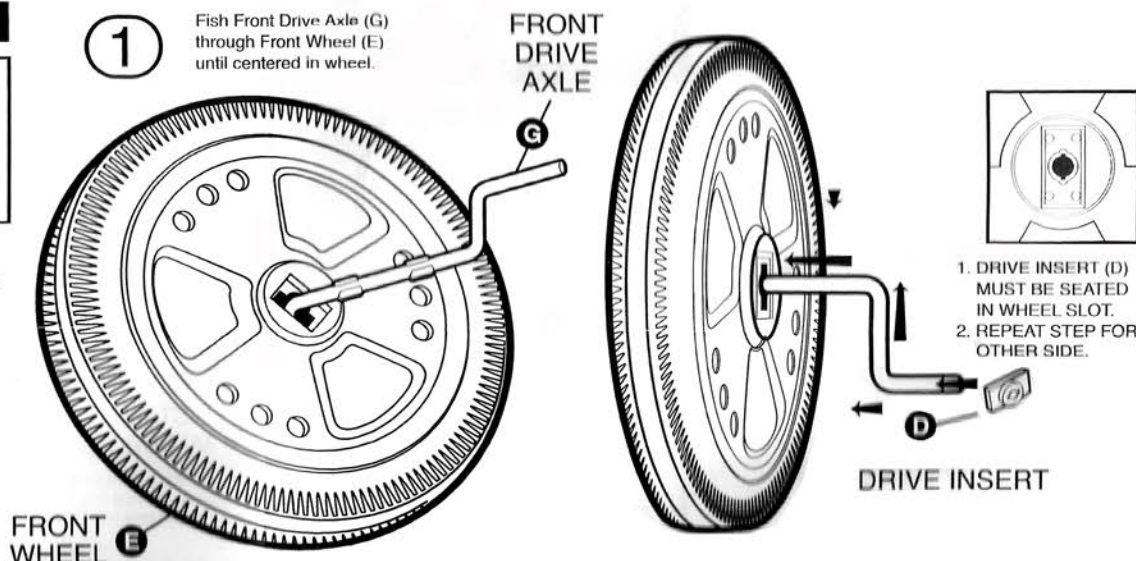

1. DRIVE INSERT (D) MUST BE SEATED IN WHEEL SLOT.  
2. REPEAT STEP FOR OTHER SIDE.

**2** INSTALL WASHERS (L) AND TINNERMAN (H) BEFORE INSTALLING PEDALS (F)

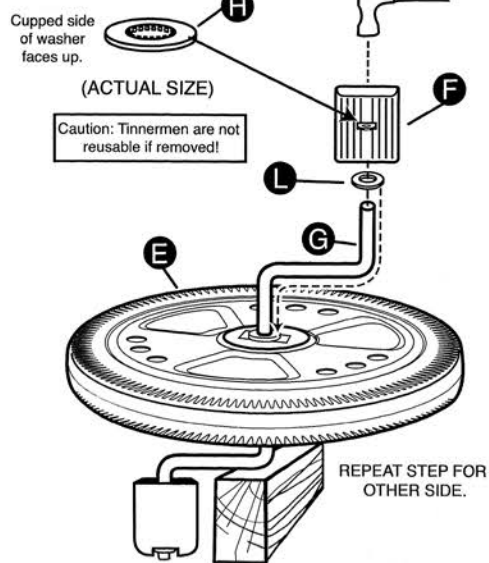

**3** ASSEMBLE WHEEL (E) TO FORK (B)

NOTE:  
1. FORK CAP (C) MUST FACE REAR OF TOY WHEN FORK IS INSTALLED IN BODY.  
2. WASHER (L) MUST BE BETWEEN FRONT WHEEL (E) AND FORK (B).  
3. REPEAT STEP FOR OTHER SIDE.

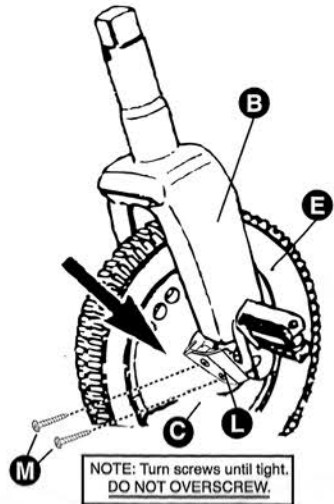

NOTE: Turn screws until tight. DO NOT OVERSCREW.

**4** INSTALL HANDLEBAR (A)

NOTE: MAKE SURE THAT THE HANDLEBAR (A) AND WHEEL ARE FACING FORWARD.

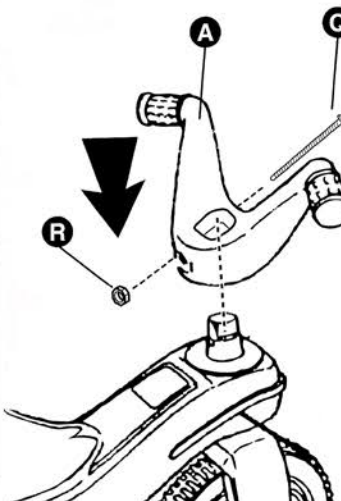

**5** ASSEMBLE REAR WHEELS (N) & AXLE (O)

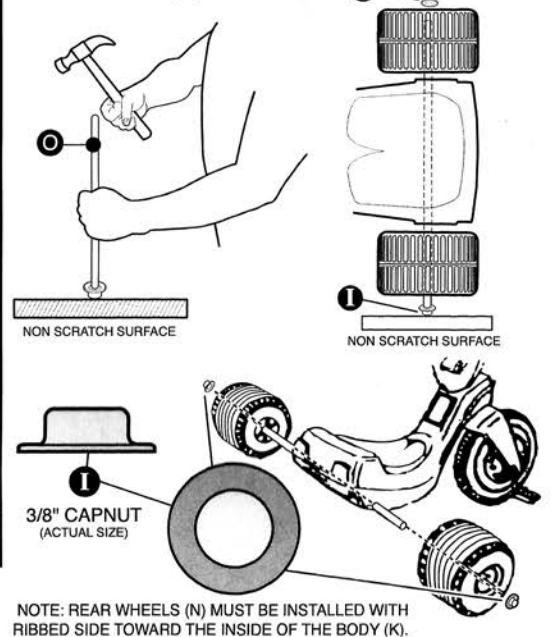

NOTE: REAR WHEELS (N) MUST BE INSTALLED WITH RIBBED SIDE TOWARD THE INSIDE OF THE BODY (K).

**Label Placement / Colocacion de Etiqueta  
Position des autocollants**

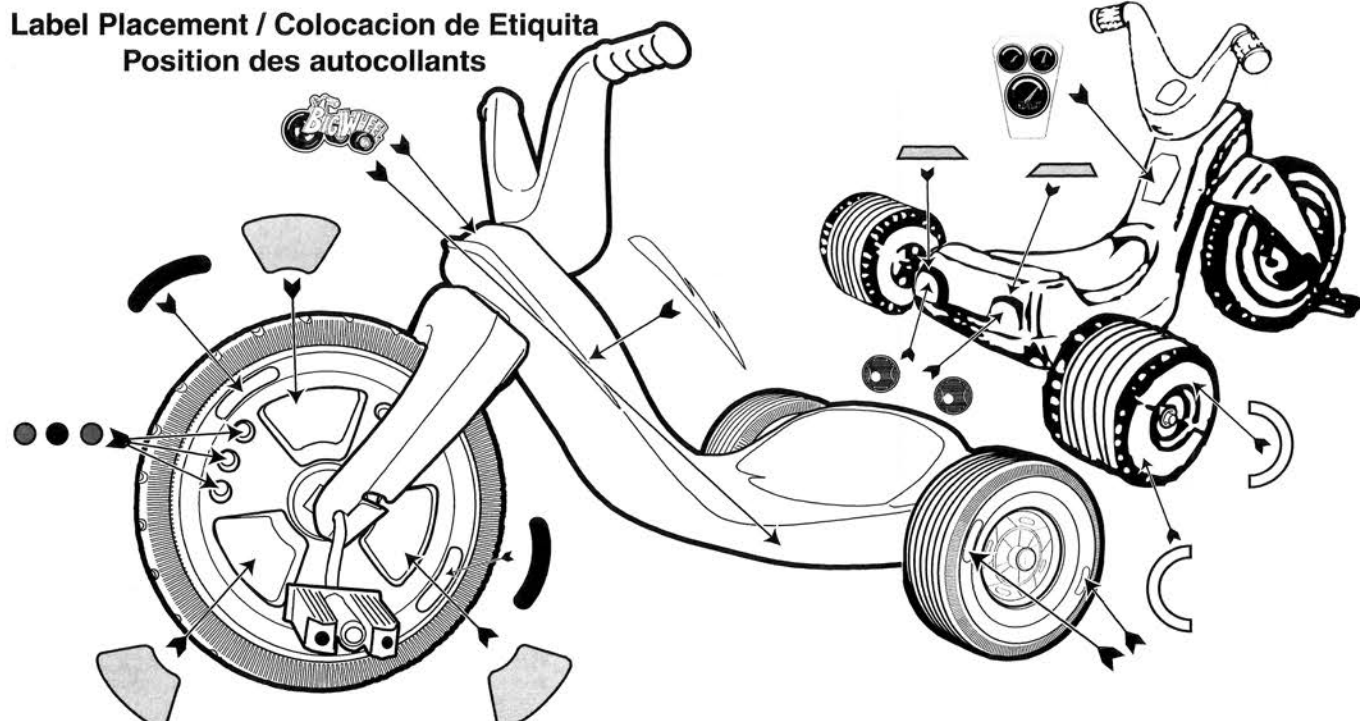

Cedar Rapids, IA 52404

Big Wheel is a registered trademark of Empire Toys.  
Big Wheel est une marque de commerce de Empire Toys.  
Big Wheel es una marca registrada de Empire Toys.  
©2019 Empire Toys.  
All Rights Reserved./Tous droits réservés.  
Todos los derechos son reservados.

Customer Service • Service à la clientèle  
Servicio Del Cliente:

**319-365-5842**